

NZ1RG-528L060-M (Order no. 090008)

Safety switch NZ.RG, roller plunger, plastic roller \varnothing 12 mm, cable entry M20 x 1.5

- ▶ Roller plunger, plastic roller \varnothing 12 mm
- ▶ Version C according to EN 50041
- ▶ Cable entry M20 x 1.5
- ▶ 1 pos. driven contact
- ▶ 1 NO contacts
- ▶ LED indicator: AC/DC 12-60 V red



Approach direction



Horizontal

Can be adjusted in 90° steps

LED indicator

The switch has one freely assignable LED indicator.

Switching element

528H Slow-action switching contact 1 positively driven contact $\ominus \rightarrow$ + 1 NO contact

Dimensional drawings

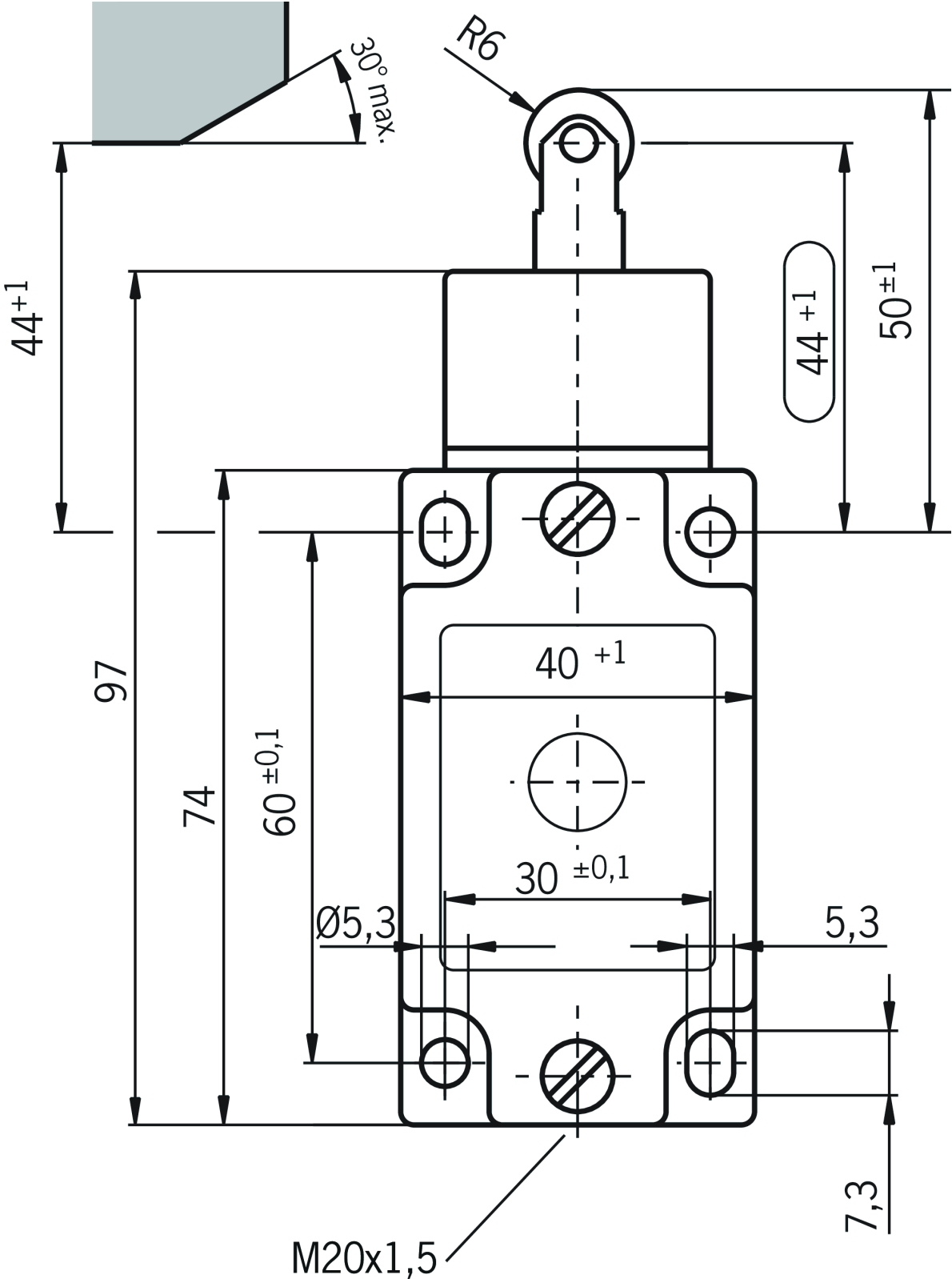

Connection examples

