

SN02D16-502-MC1939 (Order no. 088146)

Series SN... 16 mm, mechanical

- ▶ Plunger spacing 16 mm
- ▶ Upright housing, small flange
- ▶ Degree of protection IP67 according to IEC 60529



Switching element

ES 502 E Snap-action switching contact 1 NC + 1 NO

Dimensional drawings

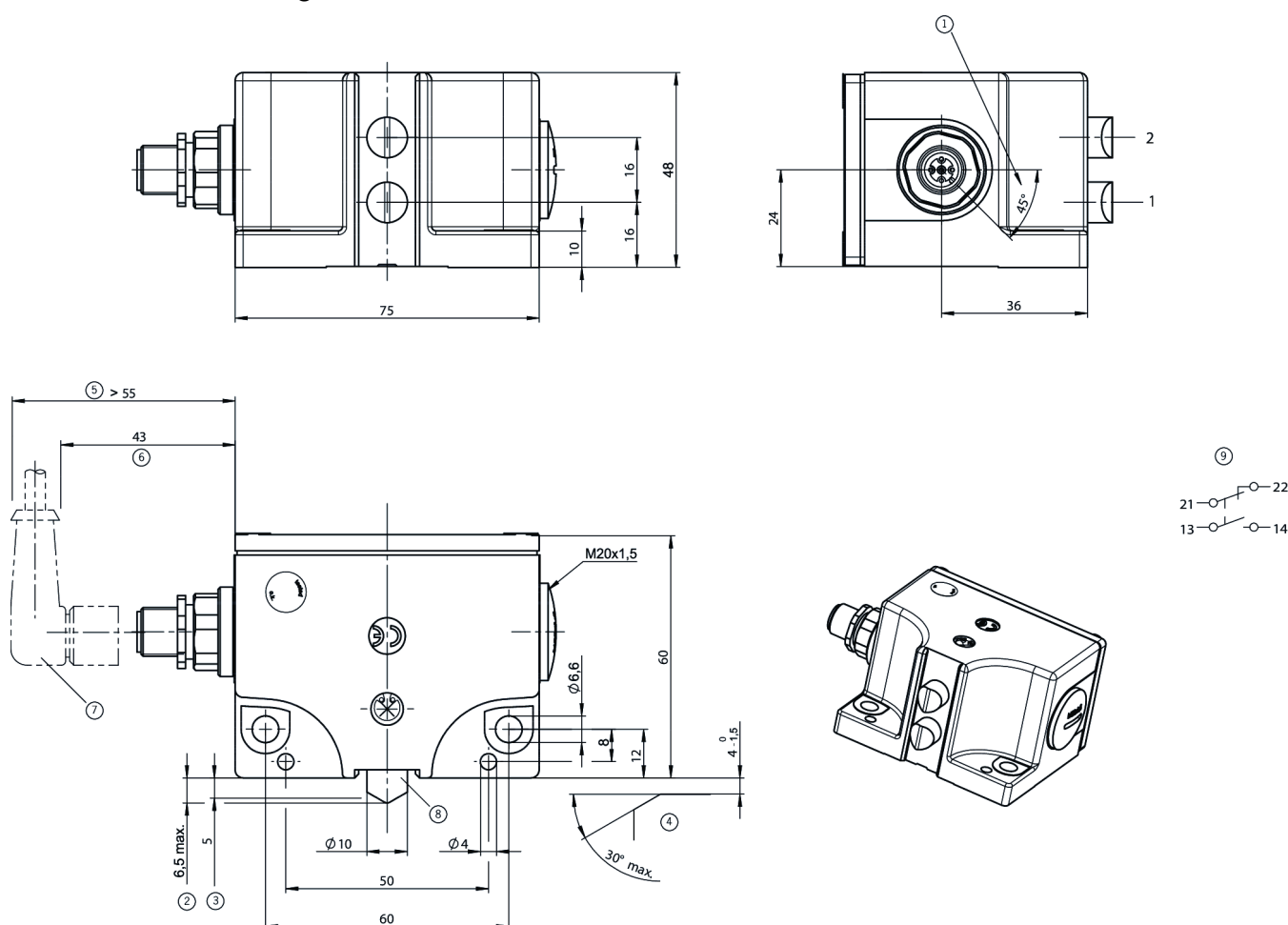

- 1 Guide lug aligned
- 2 Free position
- 3 Operating point
- 4 Dog
- 5 Right-angle plug connector
- 6 In the inserted and screwed tight state
- 7 Right-angle plug connector, cable outlet adjustable to max. 270°
- 8 A shorter mechanical life is to be anticipated if the plunger is over-actuated.
- 9 Switching element ES502E snap-action contact element: 1 normally closed contact + 1 normally open contact

Connection examples

ES 502 E

