

Project : _____
 Type : _____
 Drawn by : _____
 Catalogue No. : _____
 Date : _____



Specifications

Model No.		<input type="checkbox"/> BAK-004G
General	Rated Voltage	120V, 60Hz
	Rated Power	300W
	Switch times	≥40000 times
	Power Supply	Neutral & Live Wire & Grounding
	Installation Method	In-wall
	Application	Indoor
	Dimming Method	Slider
Load Range	Incandescent lamp	15-600W
	LED lamp	5-300W
	Low voltage halogen lamp with electronic transformer	15-600W
	CFL -- fewer than 5pcs	15-300W
	Electric resistive heat	15-600W
Physical	MOL	4.13in
	MOW	1.80in
	MOH	1.79in
	Material	Plastic+Aluminum
	Housing Color	White
	Weight (Kg)	0.07
Operating Environment	Operating Temperature	0°C (32F) TO 40°C (104F)
Additional Information	Stand	UL1472 / CSA C22.2 No.184.1-15
	Warranty	2 years
Compliance	Safety Listing	UL-Listed
	Energy Star	No
	DLC Approved	No
	DLC ID	No

Features & Specifications

Construction

- Digital circuit technology enables smooth dimming of the widest range of LEDs.
- Suitable for dimmable LEDs up to 300 watts or incandescent or halogen bulbs up to 600 watts.
- No neutral wire required.
- Features a large paddle switch for easily lights on/off control and smooth vertical slider for full range dimming.
- Tough thermoplastic housing shrugs off impacts and scratches. Energy saving and long operating life.
- Can be used in single-pole or 3-way applications.

Features

- Push button switch turn the lights ON/OFF
- Use as single pole or 3-way
- Compatible with most switch panels

Compliances

- UL certified

Dimensions & Weights

Model	BAK-004G
Length in.(cm)	4.13 (10.5)
Width in. (cm)	1.80 (4.58)
Height in. (cm)	1.79 (4.54)
Net weight (lbs)	0.07

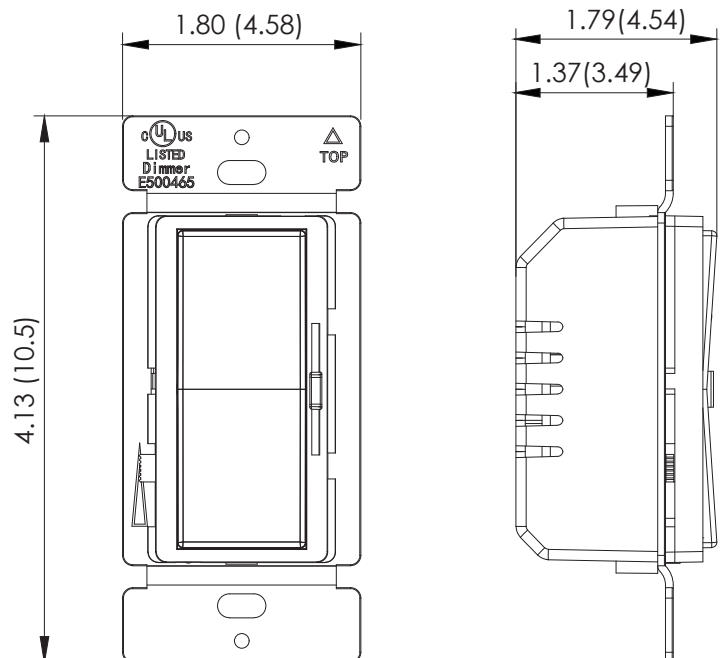

Product Details

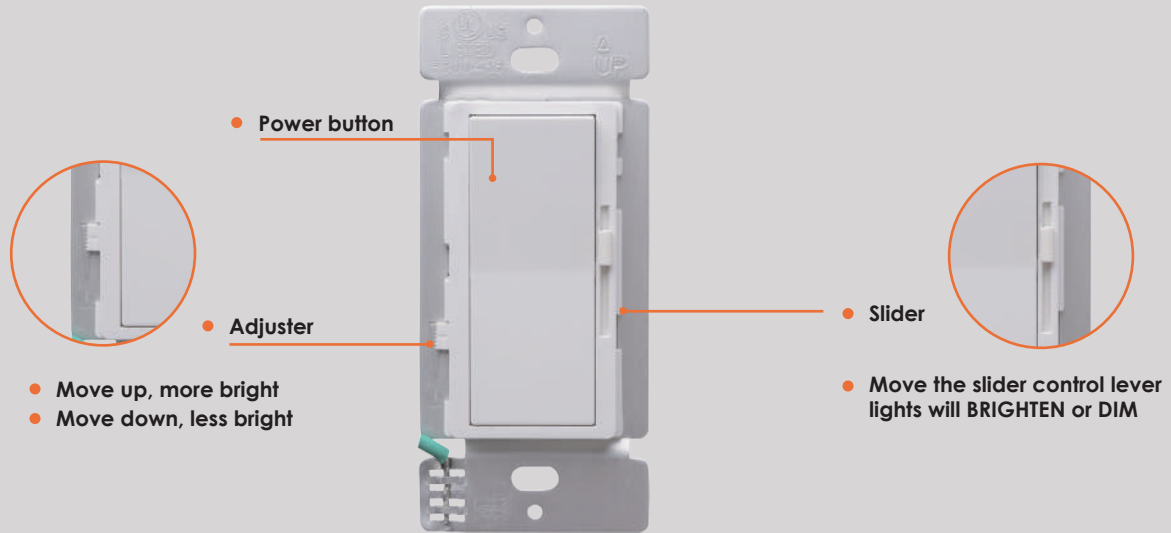

Typical Wiring Application

Turn off power at circuit breaker or fuse and test that power is off before wiring.

Install according to the wiring diagram above.

Carefully position all wires inside the wall-box, leaving enough space to insert the dimmer. Secure the dimmer with the provided mounting screws.

