

## Trip Rails



Series UFA



Series UF



Series ULA



Series UL

Housing material	Aluminium	Cast iron	Aluminium		Aluminium
Slot spacing	8 mm	8 mm	12 mm	16 mm	12 mm
Dimension at number of slots (Width in mm)	2 slots: 44 mm 3 slots: 52 mm 4 slots: 60 mm 5 slots: 68 mm 6 slots: 76 mm	2 slots: 44 mm 3 slots: 52 mm 4 slots: 60 mm 5 slots: 68 mm 6 slots: 76 mm 8 slots: 92 mm	2 slots: 29 mm 3 slots: 41 mm 4 slots: 53 mm 5 slots: 65 mm 6 slots: 77 mm	2 slots: 33 mm 3 slots: 49 mm 4 slots: 65 mm 6 slots: 97 mm	2 slots: 24 mm 3 slots: 36 mm 4 slots: 48 mm
Number of slots max.	6	8	6		4
Length max.	2010 mm	1000 mm	2010 mm		4000 mm

## Trip Dogs

For slot spacing UF8/UFA8

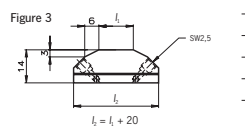
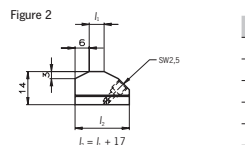
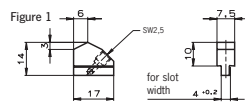

$l_1$	Figure
0	1
4	2
6,3	2
10	3
16	3
20	3
25	3
40	3
63	3
100	3

Series U8

For slot spacing ULA/UL/UF

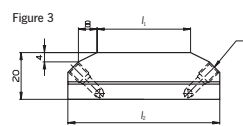
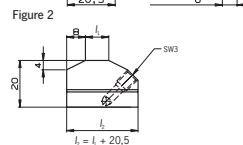
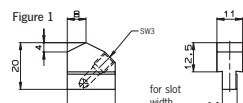

$l_1$	Figure	DIN/form
0	1	UA
4	2	UA
6,3	2	-
10	2	UA
16	3	UB
25	3	UB
40	3	UB
63	3	UB
100	3	UB
125	3	-

Series U1216

For slot spacing ULA/UL/UF

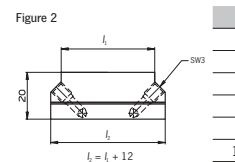
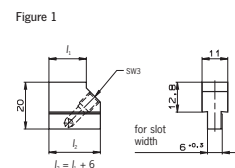

$l_1$	Figure
10	1
16	1
25	2
40	2
63	2
100	2
125	2

Series UX1216

Housing material	Hardened, ground steel		Black painted steel		
Slot spacing	8 mm	12 mm	16 mm	12 mm	16 mm