

## TQ1-0302G024-5000 (Order no. 103378)

### Safety switch TQ, connection cable, connecting cable 5m

- ▶ Connecting cable, 5 m
- ▶ Auxiliary release from 3 sides
- ▶ Switching element 0302
- ▶ LED indicator
- ▶ Closed-circuit current principle

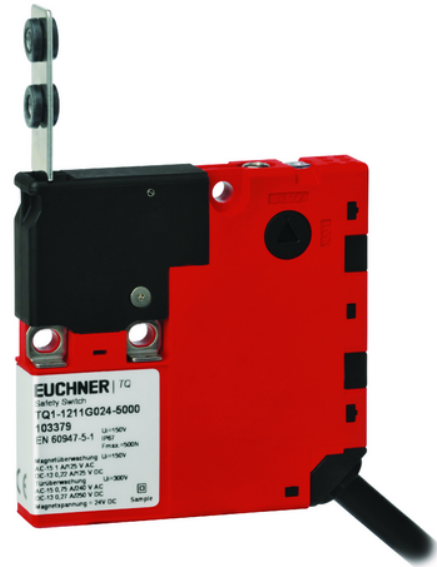

### Approach direction

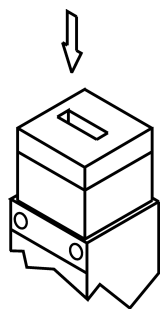

Vertical

### Guard locking principle

Power to unlock: On a guard with guard locking based on the closed-circuit current principle, the guard is locked by spring force until the guard locking solenoid is supplied with power. Unlocking is by solenoid force. The term mechanical guard locking is also used.

### Guard locking for process protection

The safety switch meets the requirements for interlocking devices with guard locking for process protection. It does not possess safe guard lock monitoring.

### Switching element

0302 Slow-action switching contact

Contacts for guard locking: 2 NC contacts

Contacts for door monitoring: 3 positively driven contacts ➞

**LED indicator**

The LED indicator illuminates when voltage is applied to the guard locking solenoid.

**Auxiliary release with triangular wedge**

The auxiliary release makes it possible to access the machine if there is a malfunction, e. g. a power failure. Unlocking is performed using a tool or a key. The auxiliary release must be protected against misuse (sealing, lacquer).

**Scope of delivery**

Triangular key for manual release is included in the scope of delivery.

**Accessories required**

Actuator is not included.

## Dimensional drawings

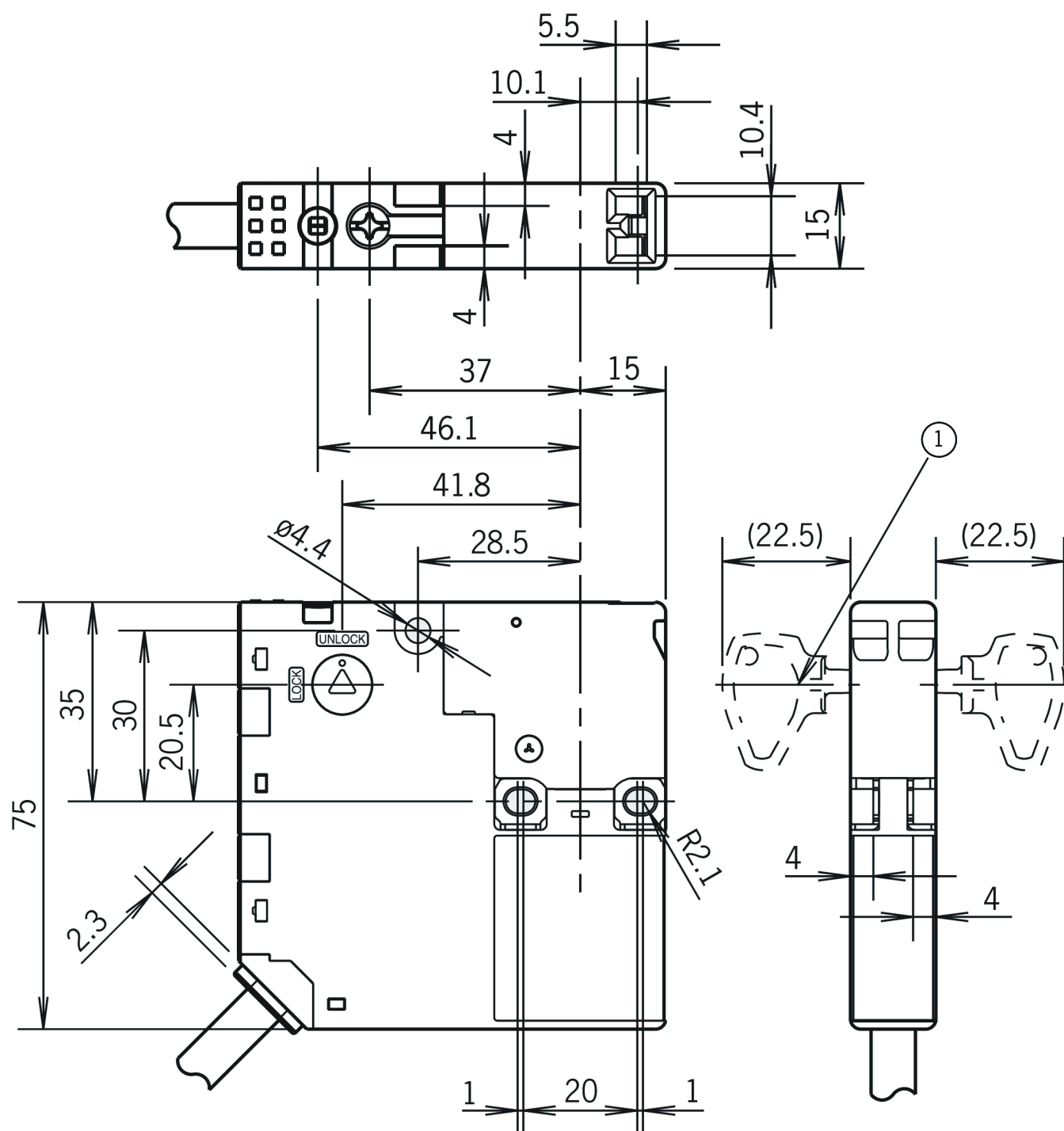

1 Triangular key