

TQ2-1202SG024-5000 (Order no. 104750)

Safety switch TQ, connection cable, connecting cable 5m

- ▶ Connecting cable, 5 m
- ▶ Auxiliary release from 3 sides
- ▶ Switching element 1202S
- ▶ LED indicator
- ▶ Open-circuit current principle

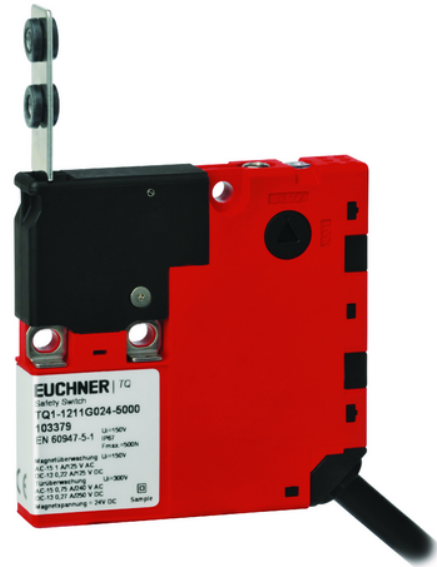

Approach direction

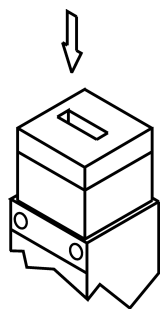

Vertical

Guard locking principle

Open-circuit current (power on to lock): On a guard with guard locking based on the open-circuit current principle, the guard is locked until the power supply to the guard locking solenoid is interrupted. Unlocking is by spring force. The term electrical guard locking is also used.

Guard locking for process protection

The safety switch meets the requirements for interlocking devices with guard locking for process protection. It does not possess safe guard lock monitoring.

Switching element

1202S Slow-action switching contact

Contacts for guard locking: 2 NC contacts

Contacts for door monitoring: 2 positively driven contacts \odot + 1 NO contact

LED indicator

The LED indicator illuminates when voltage is applied to the guard locking solenoid.

Auxiliary release with triangular wedge

The auxiliary release makes it possible to access the machine if there is a malfunction, e. g. a power failure. Unlocking is performed using a tool or a key. The auxiliary release must be protected against misuse (sealing, lacquer).

Scope of delivery

Triangular key for manual release is included in the scope of delivery.

Accessories required

Actuator is not included.

Dimensional drawings

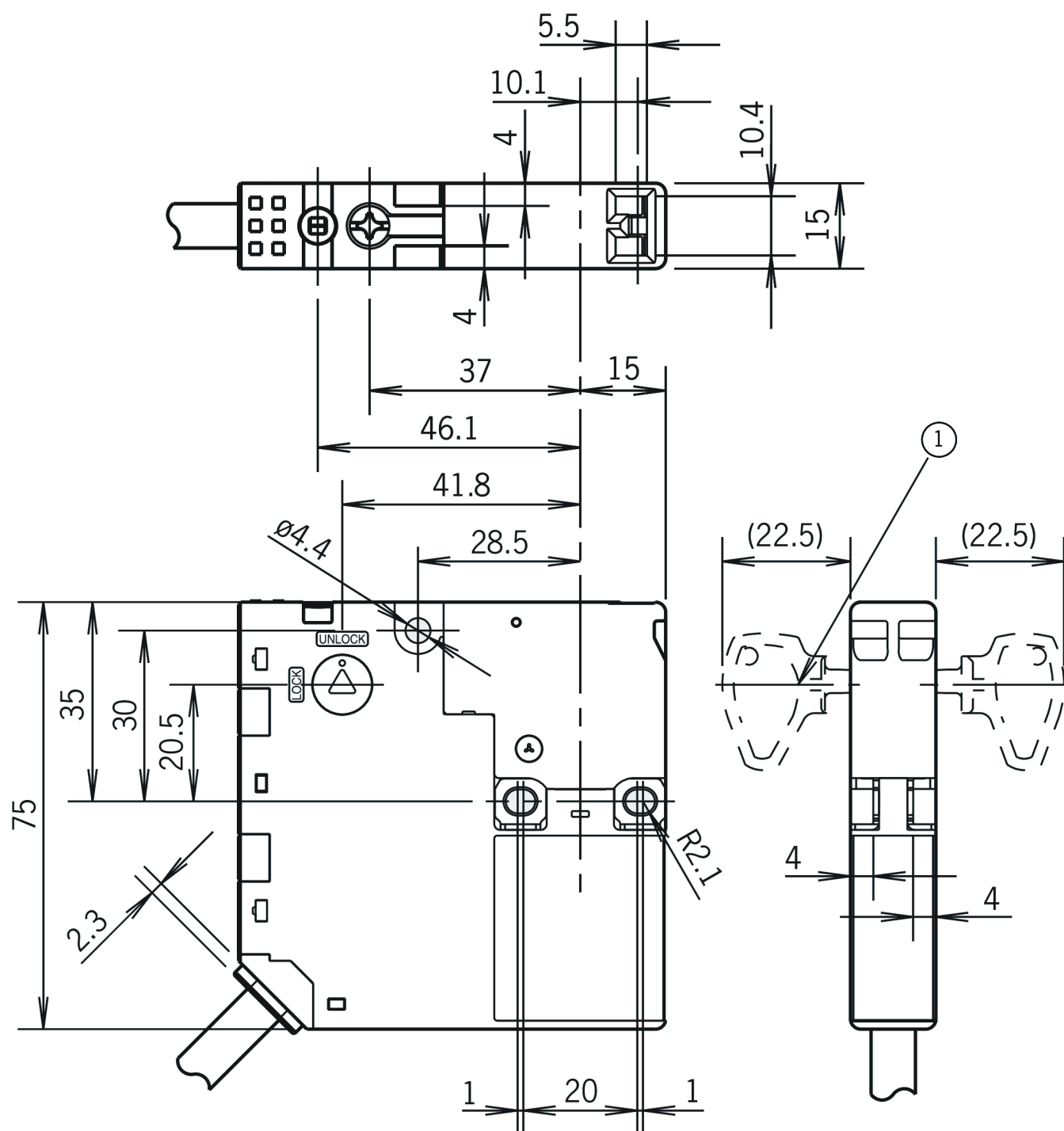

1 Triangular key