

## NZ1HB-2131-9C-GMMF (Order no. 077390)

### Safety switch NZ.HB, lever arm with plastic roller, plug connector MR9

- ▶ Lever arm, plastic roller  $\varnothing$  18 mm
- ▶ Version A according to EN 50041
- ▶ Plug connector MR9, 8-pin + PE
- ▶ 3 pos. driven contact
- ▶ 1 NO contacts



#### Approach direction



Horizontal

Can be adjusted in 90° steps

#### Switching direction adjustable

Right, left or both sides

#### Switching element

2131H Slow-action switching contact 3 positively driven contacts  $\rightarrow$  + 1 NO contact

**Dimensional drawings**

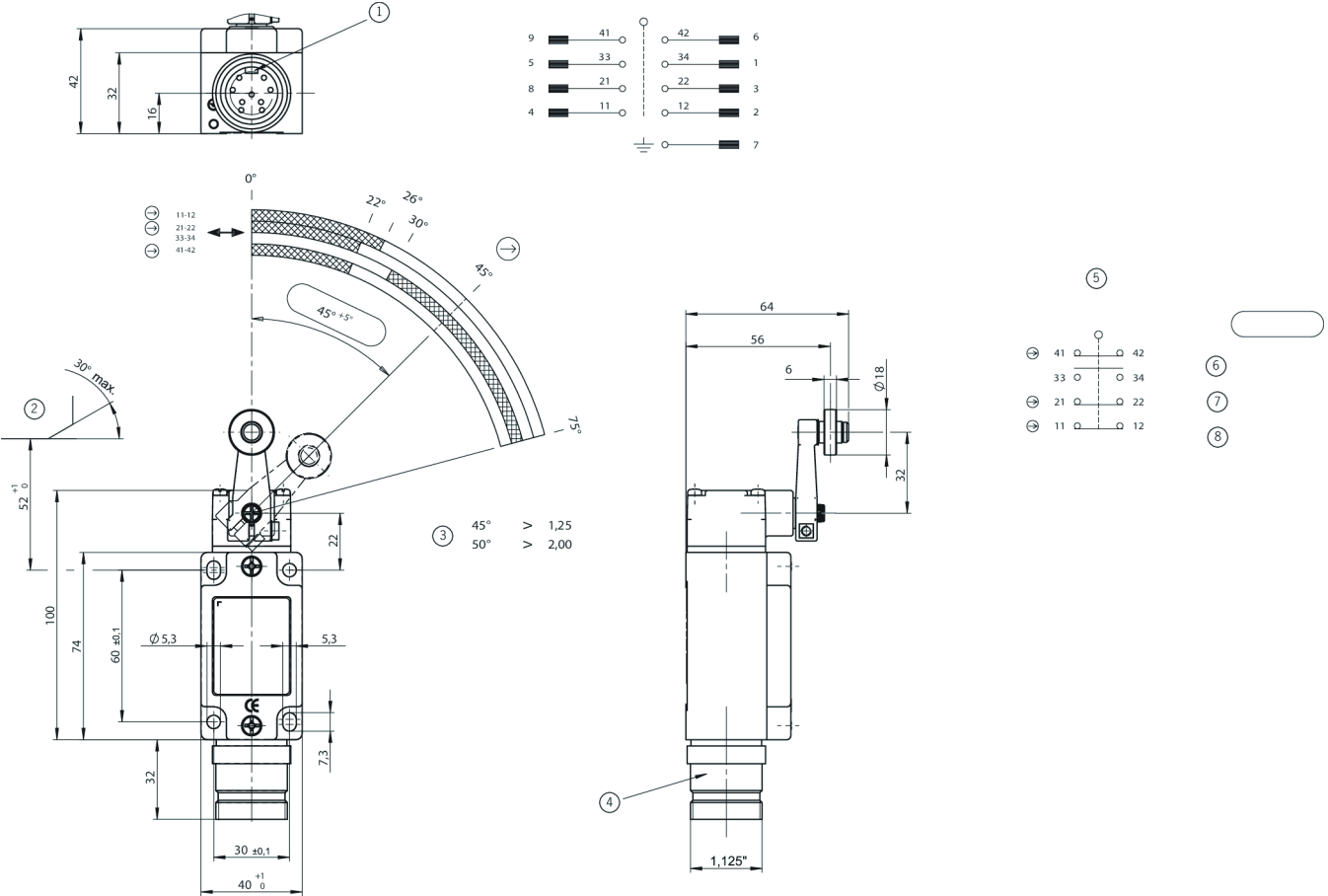

- 1 Guide lug not aligned
- 2 Dog
- 3 Contact opening gap
- 4 Plug connector MENCOR (9-pin) MIN-9MR-1-18-M20
- 5 Switching element in free position: Switching element SK 2131 H, 3 NC contacts + 1 NO contact; NC contacts positively driven
- 6 Positive opening function is dependent on maintaining this distance.
- 7 Actuator (dog) must be positively mounted on the machine.
- 8 Switch can be replaced only with the same type.

Connection examples

