

NZ1RL-3131-M (Order no. 090942)

Safety switch NZ.RL, extended roller plunger, steel roller \varnothing 18 mm, cable entry M20 x 1.5

- ▶ Extended roller plunger, steel roller \varnothing 18 mm
- ▶ Cable entry M20 x 1.5
- ▶ 2 pos. driven contact
- ▶ 2 NO contacts



Approach direction



Horizontal

Can be adjusted in 90° steps

Switching element

3131H Slow-action switching contact 2 positively driven contacts $\ominus \rightarrow$ + 2 NO contact

Dimensional drawings

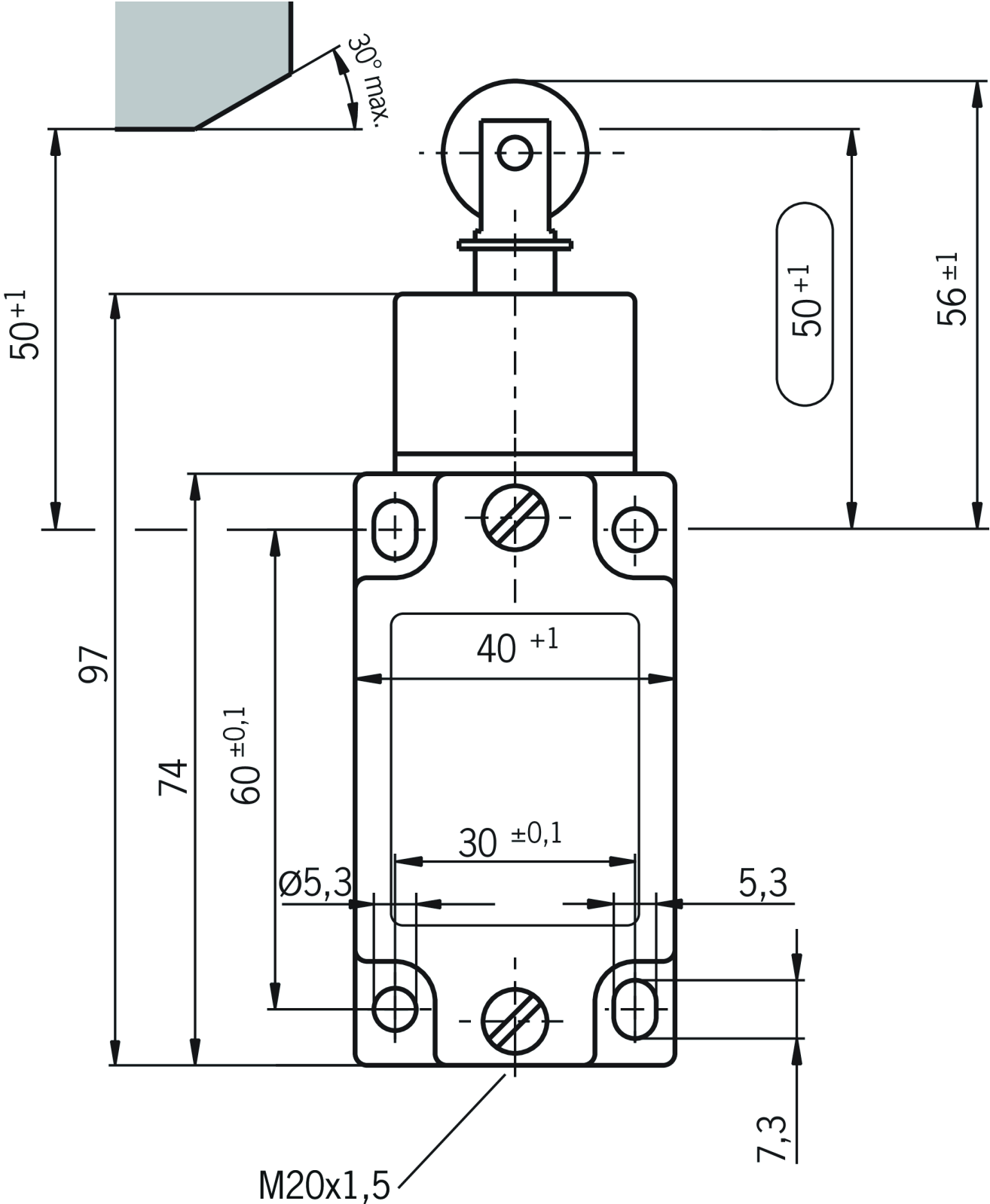

Connection examples

