

TRAC-MASTER®

Avant Garde

FRONT LAMPING OPEN BACK SPOTLIGHTS

T687, T689 and T690

Project: _____

Fixture Type: _____

Location: _____

Contact/Phone: _____

PRODUCT DESCRIPTION

The clean, functional lines of the open back allows maximum adjustability. Front Loading Open Back Spotlights relamp from the front and have fixed socket mount and on/off switch. The minimum profile with stylized yoke design is ideal for retail and commercial applications.

Construction Die formed steel.

Socket Medium base porcelain with nickel plated copper screw shell.

Aiming 90° vertical aiming capability and 358° rotation.

Juno Universal Track Adapter Universally compatible with both Trac-Master 1-circuit or 2-circuit track, Trac-Lites track, monopoints and special mountings • Also UL Recognized for use on ConTech® LT Series track • Copper alloy contacts provide precise spring action - no arcing and will not take a set • True, positive electrical ground • On/off switch included • Patented embossed polarity arrows on bottom of adapter • Spring-loaded positive latch with embossed polarity arrows secures track light to track • Two-position power contact provided for two-circuit application.

Alternate TEK Track Adapter Compatible with Juno TEK track system • System specific and assembled to track fixture • Integrally polarized construction to prevent reverse installation – only allows insertion in proper orientation • Rotary circuit selector enables simple switching between circuits • Integral on/off switch enables individual fixtures to be switched for servicing.

Alternate GTYPE Track Adapter Compatible with track systems based on GES type track, including Lithonia LT Commercial Track (not LTS type) • System specific and assembled to track fixture • Two-position power contact provided for two-circuit application • Consult factory for additional information.

Alternate HTYPE Track Adapter Compatible with track systems which use a H-type track adapter, including Lithonia LTS Decorative Track (not LT type) • System specific and assembled to track fixture • Two-position power contact provided for two-circuit application • Consult factory for additional information.

Alternate LTYPE Track Adapter Compatible with track systems which use a L-type track adapter • System specific and assembled to track fixture • Two-position power contact provided for two-circuit application • Consult factory for additional information.

Government Procurement

BAA – Buy America(n) Act: Product qualifies as a domestic end product under the Buy American Act as implemented in the FAR and DFARS. Product also qualifies as manufactured in the United States under DOT Buy America regulations.

BABA – Build America Buy America: Product qualifies as produced in the United States under the definitions of the Build America, Buy America Act.

Please refer to www.acuitybrands.com/buy-american for additional information.

Labels UL Listed • CSA Certified.

Note: Actual performance may differ as a result of end-user environment and application. Specifications subject to change without notice.



Line Voltage PAR20

Catalog Number	Description	Finish	Lamp
T687 BL	Open Back w/Juno Universal Track Adapter	Black	50W PAR20

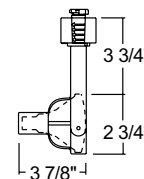

Line Voltage PAR30

Catalog Number	Description	Finish	Lamp
T689 WH	Open Back w/Juno Universal Track Adapter	White	75W PAR30
T689 BL	Open Back w/Juno Universal Track Adapter	Black	75W PAR30

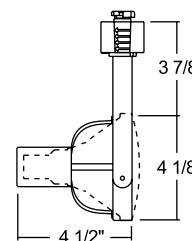

ConTech is a registered trademark of ConTech Lighting.



TRAC-MASTER®

Avant Garde

**FRONT LAMPING
OPEN BACK SPOTLIGHTS****T687, T689 and T690****Line Voltage PAR38**

Catalog Number	Description	Finish	Lamp
T690 WH	Open Back w/Juno Universal Track Adapter	White	250W PAR38
T690 BL	Open Back w/Juno Universal Track Adapter	Black	250W PAR38
T690 SL	Open Back w/Juno Universal Track Adapter	Silver	250W PAR38
T690 TEK BL	Open Back w/TEK Track Adapter	Black	250W PAR38
T690 GTYPE BL	Open Back w/G-Type Track Adapter	Black	250W PAR38
T690 HTYPE BL	Open Back w/H-Type Track Adapter	Black	250W PAR38
T690 LTYPE BL	Open Back w/L-Type Track Adapter	Black	250W PAR38

