

Trace Heating Redefined

DREXAN ENERGY SYSTEMS OFFERS THE MOST TECHNOLOGICALLY ADVANCED AND STRINGENTLY MANUFACTURED TRACE HEATING SYSTEMS THAT PROVIDE OUTSTANDING COST SAVINGS IN ENGINEERED DESIGN AND FIELD INSTALLATION.



CABLE COMPONENTS

A typical heat tracing system will include cable, cable components and controls as required (see p.1 for Approvals).

HeatShrink® Components



***HS-PC**
Power Connection
(Junction box not included)



***HS-TSPlice**
Splice Kit



***HS-ESK**
End Seal Kit



HS-JB
Junction Box
(not ATEX/UL approved)

*AMIGA Power / Tee / Splice



AMIGA is an advanced connection system designed for use with the Drexan HeatTracer family of Self-Regulating PipeGuard cables. AMIGA can connect up to three heaters to power or be used as an inline splice (no power) or inline tee (no power).

AMIGA consists of a pipe-mounted stanchion and an enclosure (junction box) with terminal blocks mounted on DIN rail. The AMIGA stanchion provides ample room in which installers can manipulate heating cables, has excellent mechanical protection for cables installed on a pipe, and permits application of up to 4 inches (102 mm) of thermal insulation.

AMIGA is CSA/UL (CUS) certified for both non-hazardous and hazardous locations up to Class I Division 2 (Zone 2). AMIGA is not ATEX-approved.

Cable Fastening Accessories

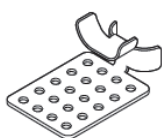

Roof Clip, RC50



Downspout Cable Support, MT-CS

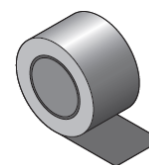

Aluminum Foil Tape, TAPE-AL