

Project: \_\_\_\_\_ Type: \_\_\_\_\_  
 Drawn by: \_\_\_\_\_ Catalogue #: \_\_\_\_\_ Date: \_\_\_\_\_

## Individual Spec Sheet

# 24 V LED DRIVER

## 5-IN-1 DIMMABLE HARDWIRE

### Class 2

### ORDERING INFORMATION

**Order Code:** 70513  
**Model Number:** LED/DRIVER/96W/24V/HW/5-IN-1D  
**UPC:** 069549035287  
**Case Quantity:** 10

### PHYSICAL DATA

**Dimensions:** 7 1/8 x 4 1/8 x 1 5/8 in (18.0 x 10.3 x 4.0 cm)  
**Type:** Hardwire Driver - Dimmable  
**Color:** Black

### PERFORMANCE DATA

**Output Power (W):** 96  
**Input Voltage (V AC):** 120-277  
**Output Voltage (V DC):** 24-26  
**Input Current (mA):** 1 100  
**Output Current (mA):** 4 000  
**Frequency (Hz):** 47/63  
**Power Factor:** ≥0.95  
**Operating Temperature:** -40 °C to 60 °C (-40 °F to 140 °F)  
**Dimming Type:** Forward and Reverse (TRIAC / ELV / MLV, 0-10 V, 1-10 V, Potentiometer, 10 V PWM)  
**Dimming Range:** 0-100 %

### DIMENSIONS

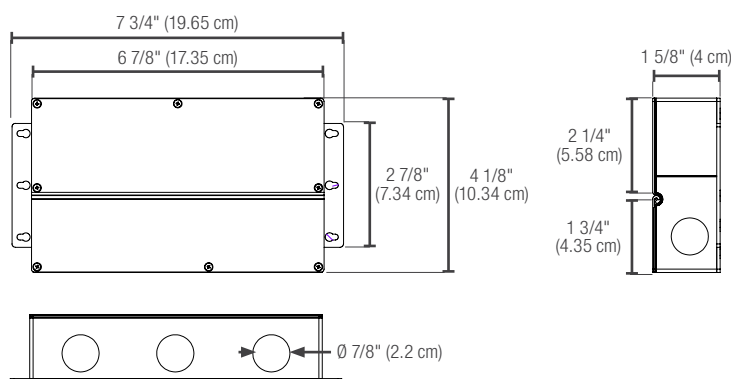

**5** yrs  
warranty



**CLASS**  
**2**  
compliant



Qty	Description	Price

I accept the specifications of the luminaire configuration mentioned above.

Name: \_\_\_\_\_  
 Company: \_\_\_\_\_  
 Signature: \_\_\_\_\_

Date: \_\_\_\_\_

Data is based upon tests performed in a controlled environment. Actual performance can vary depending on operating conditions.  
 All products are subject to change or may be discontinued any time without notice.