

TWO HOLE HYLUG™ CODE CONDUCTOR LONG BARREL (Continued)

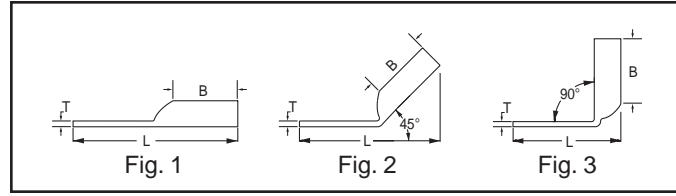

C-54

Catalog Number	Fig #	Conductor		Stud Hole Size	Stud Hole Spacing	Tongue Width	Figure Dimensions			▲ Installation Tooling							
		AWG	MM ²				(B)	(T)	(L)	Dieless (# of crimps)	Mechanical		Hydraulic		Color Code	Die Index	Wire Strip Length
											MD6, OUR840, MD7-34R	BCT500HS, Y500CTHS	Y35, Y39, Y750, Y46*, PAT750				
YA262TC38	1					.83"	1.50"	.12"	3.78"	MY29-3 (2) MY29-11 (2) MRC840 (4) Y644M (1)	W26VT (4) W26RT (4) X26RT (4)	W26VT (4) W26RT (4) X26RT (4)	U26RT (2)	Black	13	1-9/16"	
YA262TC38-45	2	2/0 AWG	70	3/8"	1"	.83"	1.50"	.12"	3.50"		MY29-3 (2) MY29-11 (2) MRC840 (4) Y644M (1)	W26VT (4) W26RT (4) X26RT (4)	W26VT (4) W26RT (4) X26RT (4)	U26RT (2)	Black	13	1-9/16"
YA262TC38-90	3								2.22"								
YA272N	1			1/2"	1-3/4"	.91"	1.50"	.13"	5.01"								
YA272N-45	2			1/2"	1-3/4"	.91"	1.50"	.13"	4.73"	MY29-3 (2) MY29-11 (2) MRC840 (4) Y644M (1)	W27VT (4) W27RT (4) X27RT (6)	W27VT (4) W27RT (4) X27RT (6)	U27RT (2)	Orange	14	1-9/16"	
YA272N-90	3								3.44"								
YA272TC14E2	1								3.38"								
YA272TC14E2-45	2	3/0 AWG	-	1/4"	3/4"	.91"	1.50"	.12"	3.10"	MY29-3 (2) MY29-11 (2) MRC840 (4) Y644M (1)	W27VT (4) W27RT (4) X27RT (6)	W27VT (4) W27RT (4) X27RT (6)	U27RT (2)	Orange	14	1-9/16"	
YA272TC14E2-90	3								1.82"								
YA272TC38	1			3/8"	1"	.90"	1.50"	.12"	3.82"								
YA272TC38-45	2			3/8"	1"	.90"	1.50"	.12"	3.54"	MY29-3 (2) MY29-11 (2) MRC840 (4) Y644M (1)	W28VT (4) W28RT (4) X28RT (6)	W28VT (4) W28RT (4) X28RT (6)	U28RT (2)	Purple	15	1-11/16"	
YA272TC38-90	3								2.25"								
YA282N	1			1/2"	1-3/4"	1.02"	1.62"	.14"	5.17"								
YA282N-45	2			1/2"	1-3/4"	1.02"	1.62"	.14"	4.88"	MY29-3 (2) MY29-11 (2) MRC840 (4) Y644M (1)	W28VT (4) W28RT (4) X28RT (6)	W28VT (4) W28RT (4) X28RT (6)	U28RT (2)	Purple	15	1-11/16"	
YA282N-90	3								3.49"								
YA282TC38	1			3/8"	1"	1.02"	1.62"	.14"	3.99"								
YA282TC38-45	2	4/0 AWG	-	3/8"	1"	1.02"	1.62"	.14"	3.69"	MY29-3 (2) MY29-11 (2) MRC840 (4) Y644M (1)	W28VT (4) W28RT (4) X28RT (6)	W28VT (4) W28RT (4) X28RT (6)	U28RT (2)	Purple	15	1-11/16"	
YA282TC38-90	3								2.30"								
YA282TC14E2	1			1/4"	3/4"	1.02"	1.62"	.14"	3.55"								
YA282TC14E2-45	2			1/4"	3/4"	1.02"	1.62"	.14"	3.25"	MY29-3 (2) MY29-11 (2) MRC840 (4) Y644M (1)	W29VT (4) W29RT (4) X29RT (8)	W29VT (4) W29RT (4) X29RT (8)	U29RT (2)	Yellow	16	1-11/16"	
YA282TC14E2-90	3								1.86"								
YA282NTC38	1			3/8"	1-3/4"	1.02"	1.62"	.14"	4.74"								
YA282NTC38-45	2			3/8"	1-3/4"	1.02"	1.62"	.14"	4.44"	MY29-3 (2) MY29-11 (2) MRC840 (4) Y644M (1)	W29VT (4) W29RT (4) X29RT (8)	W29VT (4) W29RT (4) X29RT (8)	U29RT (2)	Yellow	16	1-11/16"	
YA282NTC38-90	3								3.05"								
YA292N	1			1/2"	1-3/4"	1.11"	1.62"	.16"	5.21"								
YA292N-45	2	250 kcmil	-	1/2"	1-3/4"	1.11"	1.62"	.16"	4.94"	MY29-3 (2) MY29-11 (2) MRC840 (4) Y644M (1)	W29VT (4) W29RT (4) X29RT (8)	W29VT (4) W29RT (4) X29RT (8)	U29RT (2)	Yellow	16	1-11/16"	
YA292N-90	3								3.52"								
YA292TC38	1			3/8"	1"	1.10"	1.62"	.16"	4.02"								
YA292TC38-45	2			3/8"	1"	1.10"	1.62"	.16"	3.75"	MY29-3 (2) MY29-11 (2) MRC840 (4) Y644M (1)	W30VT (4) W30RT (4) X30RT (4)	W30VT (4) W30RT (4) X30RT (4)	U30RT (4) U28ART (4)	White	17	2"	
YA292TC38-90	3								2.34"								
YA302TC38	1			3/8"	1"	1.20"	2.00"	.16"	4.45"								
YA302TC38-45	2	300 kcmil	150	3/8"	1"	1.20"	2.00"	.16"	4.07"	MY29-3 (2) MY29-11 (2) MRC840 (4) Y644M (1)	W30VT (4) W30RT (4) X30RT (4)	W30VT (4) W30RT (4) X30RT (4)	U30RT (4) U28ART (4)	White	17	2"	
YA302TC38-90	3								2.37"								
YA302N	1			1/2"	1-3/4"	1.20"	2.00"	.16"	5.64"								
YA302N-45	2			1/2"	1-3/4"	1.20"	2.00"	.16"	5.26"	MY29-3 (2) MY29-11 (2) MRC840 (4) Y644M (1)	W31VT (4) W31RT (4) X31RT (4)	W31VT (4) W31RT (4) X31RT (4)	U31RT (4) U29ART (4)	Red	18	2-1/16"	
YA302N-90	3								3.56"								
YA312N	1			1/2"	1-3/4"	1.29"	2.00"	.18"	5.68"								
YA312N-45	2			1/2"	1-3/4"	1.29"	2.00"	.18"	5.31"	MY29-3 (2) MY29-11 (2) MRC840 (4) Y644M (1)	W31VT (4) W31RT (4) X31RT (4)	W31VT (4) W31RT (4) X31RT (4)	U31RT (4) U29ART (4)	Red	18	2-1/16"	
YA312N-90	3								3.60"								
YA312TC14E2	1			1/4"	3/4"	1.29"	2.00"	.18"	4.05"								
YA312TC14E2-45	2	350 kcmil	185	1/4"	3/4"	1.29"	2.00"	.18"	3.68"	MY29-3 (2) MY29-11 (2) MRC840 (4) Y644M (1)	W31VT (4) W31RT (4) X31RT (4)	W31VT (4) W31RT (4) X31RT (4)	U31RT (4) U29ART (4)	Red	18	2-1/16"	
YA312TC14E2-90	3								1.97"								
YA312TC38	1			3/8"	1"	1.29"	2.00"	.18"	4.49"								
YA312TC38-45	2			3/8"	1"	1.29"	2.00"	.18"	4.12"	MY29-3 (2) MY29-11 (2) MRC840 (4) Y644M (1)	W32VT (4) W32RT (4) X32RT (4)	W32VT (4) W32RT (4) X32RT (4)	U32RT (4) U30ART (4)	Blue	19	2-3/16"	
YA312TC38-90	3								2.41"								
YA322N	1			1/2"	1-3/4"	1.38"	2.12"	.19"	5.85"								
YA322N-45	2	400 kcmil	-	1/2"	1-3/4"	1.38"	2.12"	.19"	5.47"	MY29-3 (2) MY29-11 (2) MRC840 (4) Y644M (1)	W32VT (4) W32RT (4) X32RT (4)	W32VT (4) W32RT (4) X32RT (4)	U32RT (4) U30ART (4)	Blue	19	2-3/16"	
YA322N-90	3								3.64"								

▲ See tooling section of this catalog for complete tool and die listings.
 * Use PUADP-1 adaptor with "U" -dies in Y46 HYPRESS™.
 ** P-RT die sets for use in Y46 HYPRESS™ only, PUADP-1 adaptor not required.

*** The MM² conductor sizes listed are the recommendations for Class 2 conductor.
 * Available undrilled. Add suffix "U" to catalog number (example: YA25U).

◆ For applications greater than 2000 Volts consult cable manufacturer for voltage stress relief instructions.

TWO HOLE HYLUG™ CODE CONDUCTOR LONG BARREL (Continued)

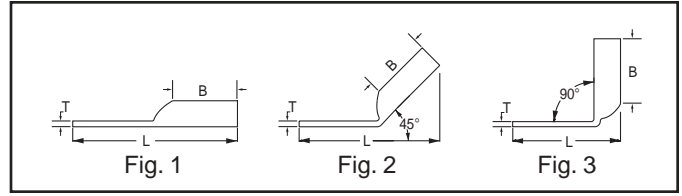
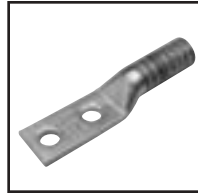

Catalog Number	Fig #	Conductor		Stud Hole Size	Stud Hole Spacing	Tongue Width	Figure Dimensions			▲ Installation Tooling								
		AWG	MM ²				(B)	(T)	(L)	Dieless (# of crimps)	Mechanical		Hydraulic		Color Code	Die Index	Wire Strip Length	
											MD6, OUR840, MD7-34R	BCT500HS, Y500CTHS	Y35, Y39, Y750, Y46*, PAT750					
YA322TC38	1																	
YA322TC38-45	2	400 kcmil	-	3/8"	1"	1.38"	2.12"	.19"	4.66"									
YA322TC38-90	3								4.28"		W32VT (4)	W32RT (4)	U32RT (4) U30RT (4)	Blue	19		2-3/16"	
YA332N	1								2.46"									
YA332N-45	2	450 kcmil	-	1/2"	1-3/4"	1.48"	2.12"	.21"	5.93"									
YA332N-90	3								5.57"		W33VT (4)	W33RT (4)	U33RT	Gray	326		2-3/16" 2-5/16"	
YA342N	1								3.70"									
YA342N-45	2			1/2"	1-3/4"	1.52"	2.25"	.23"	6.06"									
YA342N-90	3								5.72"									
YA342TC14E2	1								3.73"									
YA342TC14E2-45	2	500 kcmil	240	1/4"	3/4"	1.55"	2.25"	.23"	4.46"									
YA342TC14E2-90	3								4.09"		W34VT (4)	W34RT (4)	U34RT (4) U31ART (4)	Brown	20		2-1/2"	
YA342TC38	1								2.10"									
YA342TC38-45	2			3/8"	1"	1.55"	2.25"	.23"	4.90"									
YA342TC38-90	3								4.53"									
YA352N	1								2.54"									
YA352N-45	2	550 kcmil	-	1/2"	1-3/4"	1.65"	2.63"	.25"	6.49"									
YA352N-90	3								6.06"				U35RT (4)	Yellow	21		2-11/16"	
YA362N	1								3.77"									
YA362N-45	2			1/2"	1-3/4"	1.69"			6.59"									
YA362N-90	3								6.17"									
YA362TC38	1	600 kcmil	300				2.69"	.27"	3.81"				U36RT (4) U32ART (4)	Green	22		2-3/4"	
YA362TC38-45	2			3/8"	1"	1.74"	2.69"	.26"	5.59"									
YA362TC38-90	3								5.17"									
YA372N	1								2.81"									
YA372N-45	2	650 kcmil	-	1/2"	1-3/4"	1.80"	2.81"	.27"	6.74"									
YA372N-90	3								6.29"				U37RT (4)	Orange	23		2-7/8"	
YA382N	1								3.84"									
YA382N-45	2			1/2"	1-3/4"	1.84"	2.81"	.27"	6.77"									
YA382N-90	3								6.29"									
YA382TC38	1	700 kcmil	-						3.84"									
YA382TC38-45	2			3/8"	1"	1.84"	2.81"	.27"	5.76"				U38RT (4)	Pink	400		2-7/8"	
YA382TC38-90	3								5.29"									
YA392N	1								2.84"									
YA392N-45	2			1/2"	1-3/4"	1.89"	2.88"	.27"	6.87"									
YA392N-90	3								6.38"									
YA392NT38	1								3.87"									
YA392NT38-45	2	750 kcmil	-	3/8"	1"	1.63"	2.88"	.27"	5.87"				U39RT (4) P39RT (4) **	Black	24		2-3/4"	
YA392NT38-90	3								5.38"									
YA392TC38	1								2.87"									
YA392TC38-45	2			3/8"	1"	1.91"	2.88"	.27"	5.87"									
YA392TC38-90	3								5.38"									
YA402N	1								2.87"									
YA402N-45	2	800 kcmil	400	1/2"	1-3/4"	1.95"	2.94"	.30"	6.95"									
YA402N-90	3								6.50"				P40RT (4) **	Orange	25		3"	
YA412N	1								3.91"									
YA412N-45	2	850 kcmil	-	1/2"	1-3/4"	2.01"	2.94"	.31"	6.96"									
YA412N-90	3								6.52"					Gold	26		3"	

C-55

▲ See tooling section of this catalog for complete tool and die listings.
 * Use PUADP-1 adaptor with "U" -dies in Y46 HYPRESS™.
 ** P-RT die sets for use in Y46 HYPRESS™ only, PUADP-1 adaptor not required.

*** The MM² conductor sizes listed are the recommendations for Class 2 conductor.
 " Available undrilled. Add suffix "U" to catalog number (example: YA25U).
 ◆ For applications greater than 2000 Volts consult cable manufacturer for voltage stress relief instructions.