

BRITECH



Owner's Guide

Guide du propriétaire
Guía para el usuario

TH115-AF-GB-10

Programmable thermostat

Thermostat programmable

Termostato programable

Read and save these instructions.

Veillez lire le mode d'emploi et le conserver en lieu sûr.

Estas instrucciones deben leerse y conservarse.

Table of contents

Overview

Before you start	2
About your thermostat	3
Quick reference to controls	4
Quick reference to display	5

Installation

Installing the thermostat	6
Wiring diagram	7
Floor sensor / remote control connections	8
Configuration switches	9

Setup

Clock and day	10
Daylight Saving Time	11
Floor temperature limits	12
Preset temperatures	13

Default schedule (Energy Star settings)	14
Modifying the schedule	15

Operation

Running the schedule (automatic mode)	16
Temporary override of schedule	16
Permanent override (manual mode)	17
Going on vacation (vacation mode)	17
Ground fault protection (GFCI)	18

Appendices

Error messages	20
Technical specifications	21
Customer assistance	22
Warranty	23

Before you start

Read the entire document

CAUTION:

- Installation must be carried out by an electrician and must comply with national and local electrical codes.
- Use this thermostat only for resistive load.
- Do NOT install the thermostat in an area where it can be exposed to water or rain.
- To prevent severe shock or electrocution, always turn the power OFF at the service panel before working with wiring.
- Install the thermostat onto an electrical box.
- Use special CO/ALR solderless connectors if you connect the thermostat to aluminum wires.
- Keep the thermostat's top and bottom air vents (openings) clean and unobstructed at all times.

About your thermostat

The TH115 programmable thermostat has three temperature control modes:

- | | |
|-----------------|--|
| A mode: | ▶ controls the ambient air temperature |
| F mode: | ▶ controls the floor temperature using an external temperature sensor |
| AF mode: | ▶ controls the ambient air temperature
▶ maintains the floor temperature within desired limits using an external temperature sensor |

See page 9 on how to change the temperature control mode setting.

Supplied Parts

- One (1) power base
- Two (2) mounting screws
- Four (4) solderless connectors for copper wires
- One (1) floor sensor
- One (1) flat-tip screwdriver

Quick reference to controls

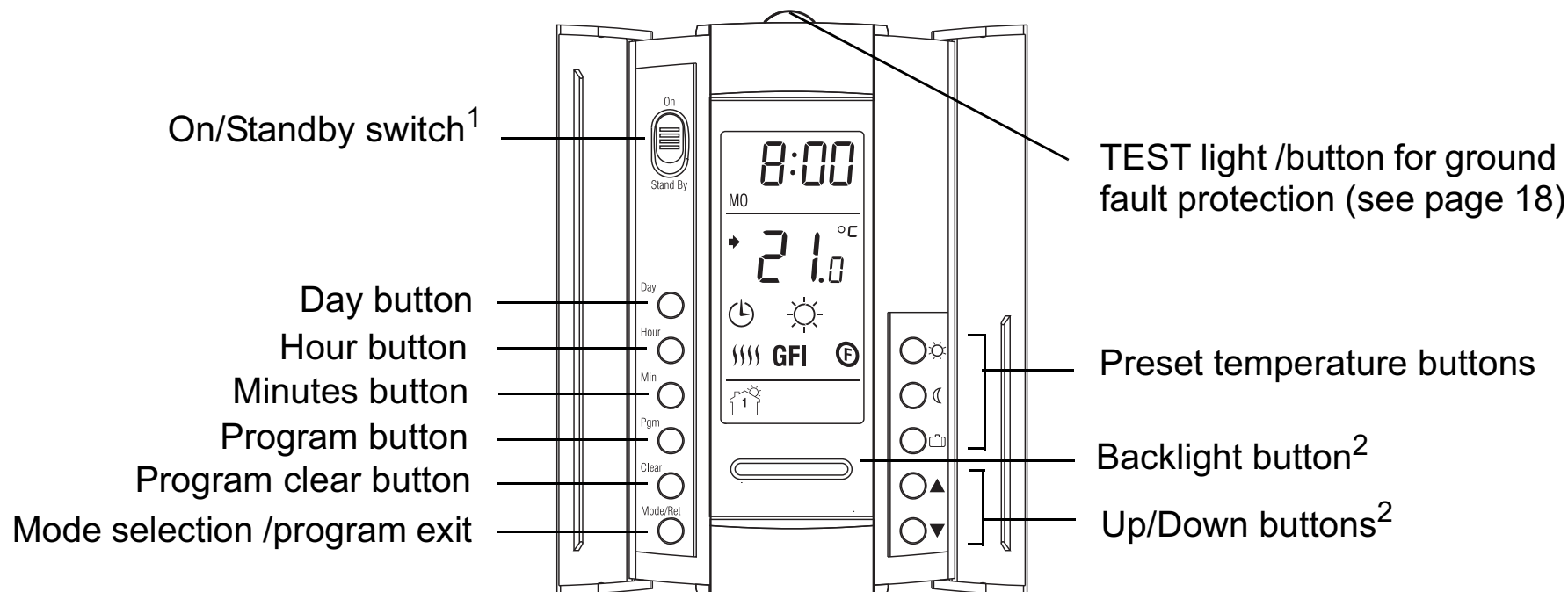

¹ Place on Standby to cut power to the heater (e.g., in the summer). This will not affect the time and temperature settings.

² When the backlight button or either of the ▲▼ (Up/Down) buttons is pressed, the display illuminates for 12 seconds.

Quick reference to display

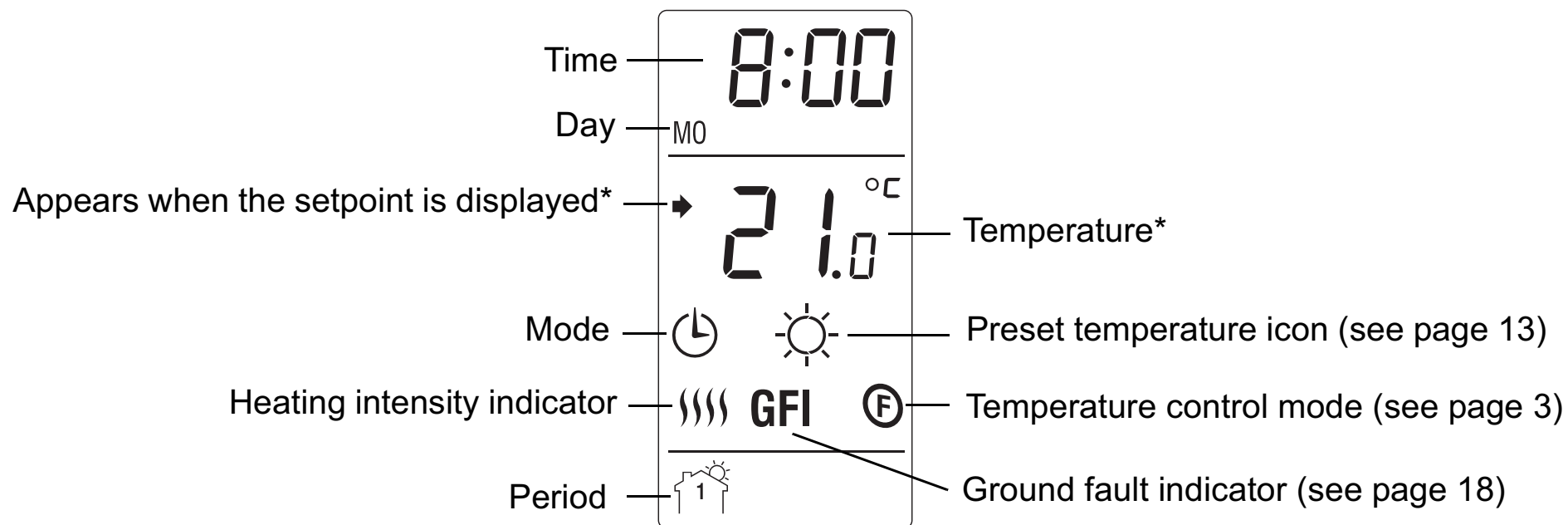

* The thermostat normally displays the actual (measured) temperature. To view the setpoint, press either of the ▲▼ buttons once. The setpoint will appear for the next 5 seconds. To change the setpoint, press one of the buttons until the desired temperature is displayed. To scroll faster, press and hold the button.

Installing the thermostat

- ① Turn off power to the heating system at the service panel.
- ② Loosen the captive screw and remove the thermostat faceplate from the wallplate. (The screw remains captive and cannot be completely removed.)
- ③ Connect the thermostat to the power supply and to the load (see page 7).
- ④ Connect the floor sensor (see page 8).
- ⑤ If you wish to connect a remote control device, see page 8.
- ⑥ Install the wallplate to the electrical box using the provided screws.
- ⑦ Set the configuration switches on the back of the faceplate (see page 9).
- ⑧ Install the faceplate on the wall plate and tighten the captive screw.
- ⑨ Apply power to the heating system.
- ⑩ Test the ground fault protection (see page 19).

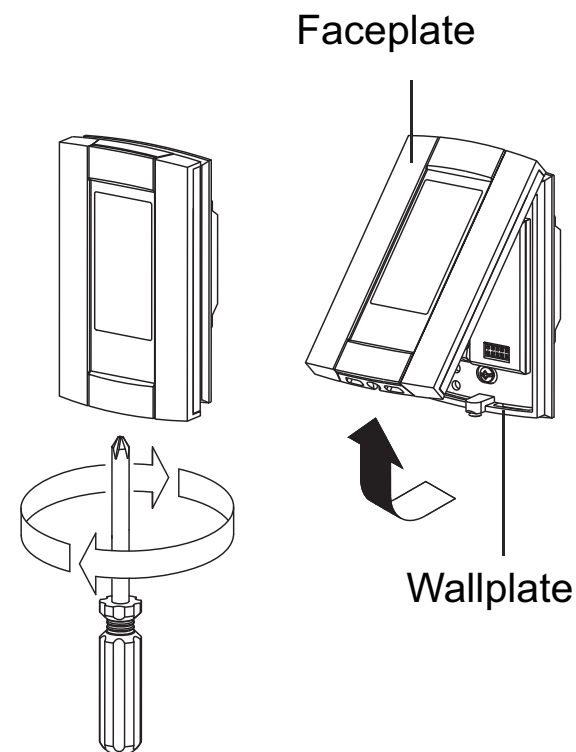

Wiring diagram

NOTE: Connect the wires using the provided solderless connectors for copper wires:

240 V

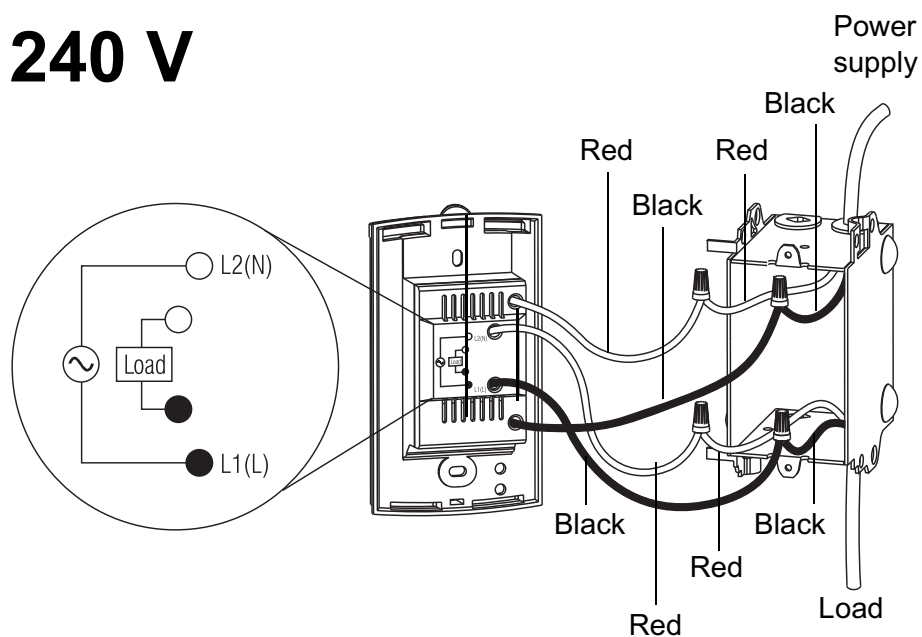

120 V

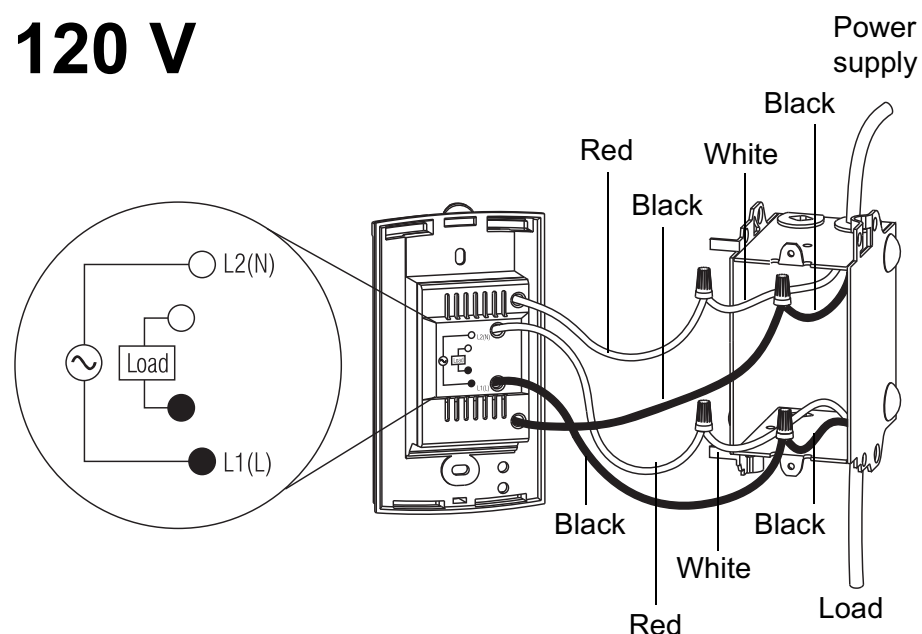

Floor sensor / remote control connections

- 1 Insert the floor sensor cable through one of the two openings on the wallplate and connect the sensor wires to terminals 1 and 2 (no polarity).
 - The sensor cable must pass outside the electrical box and follow the wall down to the floor.
 - Position the sensor cable such that it does not come in contact with the floor heating wires. The sensor must be centered between two floor heating wires for best temperature control.
 - Do NOT staple the sensor head (the plastic end) to the floor. Doing so might damage the sensor. Any damages might not be noticeable during testing but can become apparent several days later.

- 2 If you wish to connect a remote control device, insert the wires (use 18- to 22-gauge flexible wires) through one of the two openings on the wallplate and connect them to terminals 2 and 3 (no polarity). Connecting a remote device enables you to place the thermostat on vacation mode from a remote location. See page 17.

