

# Bulletin 800T/H

## 30.5 mm Push Buttons

### Pilot Lights

#### Pilot Light Devices\*



Transformer Type Pilot Light  
Cat. No. 800T-P16R



Push-to-Test Pilot Light  
Cat. No. 800T-PT16R

Type	Lamp Type	Volts	Color	Type 4/13		Type 4/4X/13	
				Pilot Light	Push-to-Test*	Pilot Light	Push-to-Test*
				Cat. No.	Cat. No.	Cat. No.	Cat. No.
Operator Only*				800T-S00	800T-SB00XX	800H-SR00	800H-SRB00XX
Full Voltage†	Incandescent	24V AC/DC	Red	800T-Q24R	800T-QT24R	800H-QR24R	800H-QRT24R
			Green	800T-Q24G	800T-QT24G	800H-QR24G	800H-QRT24G
			Amber	800T-Q24A	800T-QT24A	800H-QR24A	800H-QRT24A
	No Lamp	0...250V AC/DC	No Lens	800T-QN25	800T-QTN25	—	—
Universal†	LED	12...130 V AC/DC	Red	800T-QH2R	800T-QTH2R	800H-QRH2R	800H-QRTH2R
			Green	800T-QH2G	800T-QTH2G	800H-QRH2G	800H-QRTH2G
			Amber	800T-QH2A	800T-QTH2A	800H-QRH2A	800H-QRTH2A
Transformer†	Incandescent	120V AC, 50/60 Hz	Red	800T-P16R	800T-PT16R	800H-PR16R	800H-PRT16R
			Green	800T-P16G	800T-PT16G	800H-PR16G	800H-PRT16G
			Amber	800T-P16A	800T-PT16A	800H-PR16A	800H-PRT16A
	LED		Red	800T-PH16R	800T-PTH16R	800H-PRH16R	800H-PRTH16R
			Green	800T-PH16G	800T-PTH16G	800H-PRH16G	800H-PRTH16G
			Amber	800T-PH16A	800T-PTH16A	800H-PRH16A	800H-PRTH16A
	No Lamp		No Lens	800T-PN16	800T-PTN16	—	—

\* Includes one standard Cat. No. 800T-XA (1 N.O. - 1 N.C.) contact block. For typical pilot light wiring diagrams, see page 10-65.

\* Operator only supplied without power module, lamp, lens cap, or contact blocks.

† All pilot lights except push-to-test without sealed contacts and dual input transformer relay, are rated for Class 1, Division 2 applications.

800 T - P T 16 G AR (Push-to-Test)

a b c d e f g h

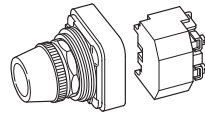

Protection Rating	
Code	Description
T	Metal, Type 4/13
H	Plastic, Type 4/4X/13

Finger-Safe Guards	
Code	Description
Blank	No guards
C	Guards on terminals

Power Module Type		
800T Type 4/13	Description	800H Type 4/4X/13
Code		Code
P	Transformer (or dual input)	PR
Q	Full voltage/ Universal	QR

Lamp Test Options	
Code	Description
Blank	No test option
T	Push-to-test
D	Dual input — diode*
DT	Dual input — transformer relay

**Note:** Push-to-test supplied with factory jumpered contact block.

Illumination Options	
Code	Description
Blank	Incandescent
H	LED*

Voltage	
Transformer	
Code	Description
16	120V AC 50/60 Hz
26	240V AC 50/60 Hz
46	480V AC 50/60 Hz
56	600V AC 50/60 Hz
Full Voltage — Incandescent	
12	12V AC/DC
24	24V AC/DC
48	48V AC/DC
10	120V AC/DC
20	240V AC/DC
Universal — LED	
2	12...130V AC/DC
Dual Input	
16	120V AC
24	24V AC/DC (Dual input diode only)

Lens Color		
Code	Color	Glass Code
Blank	No lens	Blank
A	Amber	D
B	Blue	E
C	Clear	F
G	Green	H
R	Red	J
W	White	K

Contact Blocks (Push-to-test units only)	
Code	Description
Standard	
Blank	1 N.O. - 1 N.C.
PenTUFF (Low Voltage)	
AV	1 N.O. - 1 N.C.
Class 1, Div. 2/Zone 2	
Logic Reed	
AR	1 N.O. - 1 N.C.
Sealed Switch	
AP	1 N.O. - 1 N.C.
Stackable Sealed Switch	
AY	1 N.O. - 1 N.C.

- \* LED illumination option is not available with diode type dual input.
- \* Diode type dual input provides circuit isolation via opposing diodes. Not recommended for use with solid-state outputs.
- \* Glass lens available on 800T pilot lights only. Not available on push-to-test units.

**2-Position Red Push-Pull and Push-Pull/Twist Release Devices, Non-Illuminated**

**Note:** A jumbo or large legend plate is recommended, if space allows.



2-Position Push-Pull  
 Cat. No. 800T-FX6D4



2-Position Metal Push-Pull  
 Cat. No. 800T-FXLE6D4S



2-Position Push-Pull / Twist  
 Cat. No. 800T-FXT6D4



2-Position Push-Pull / Twist  
 Cat. No. 800H-FRXT6D4

Contact Type	Operator Position		Type 4/13		Type 4/4X/13	
			Push-Pull — 40 mm	Push-Pull — 63 mm Metal	Push-Pull/Twist Release	Push-Pull/Twist Release
	Out	In	Cat. No.	Cat. No.	Cat. No.	Cat. No.
N.C.L.B.*	X	O	<b>800T-FX6D4</b>	<b>800T-FXLE6D4</b>	<b>800T-FXT6D4</b>	<b>800H-FRXT6D4</b>
N.O. - N.C.L.B.*	O	X	<b>800T-FX6A1</b>	<b>800T-FXLE6A1</b>	<b>800T-FXT6A1</b>	<b>800H-FRXT6A1</b>
N.C.L.B. - N.C.L.B.*	X	O	<b>800T-FX6A5</b>	<b>800T-FXLE6A5</b>	<b>800T-FXT6A5</b>	<b>800H-FRXT6A5</b>
S.M.C.B.*†	X	O	<b>800TC-FX6D4S</b>	<b>800TC-FXLE6D4S</b>	<b>800TC-FXT6D4S</b>	<b>800HC-FRXT6D4S</b>
N.O. - S.M.C.B.*†	O	X	<b>800TC-FX6A1S</b>	<b>800TC-FXLE6A1S</b>	<b>800TC-FXT6A1S</b>	<b>800HC-FRXT6A1S</b>
S.M.C.B. - S.M.C.B.*†	X	O	<b>800TC-FX6A5S</b>	<b>800TC-FXLE6A5S</b>	<b>800TC-FXT6A5S</b>	<b>800HC-FRXT6A5S</b>

**Note:** X = Closed/O = Open

**Note:** These caps are only available in plastic.

**Note:** Emergency stop push buttons are compliant with EN ISO 13850 and EN/IEC 60947-5-5 Standards when using N.C.L.B. contact blocks.

\* The Self Monitoring Contact Block (S.M.C.B.) is composed of a N.C.L.B. contact wired in series with a N.O. monitoring contact. The N.O. monitoring contact automatically closes when the S.M.C.B. is properly installed onto the E-stop operator. If the S.M.C.B. is separated from the E-stop operator, the N.O. monitoring contact will automatically open.

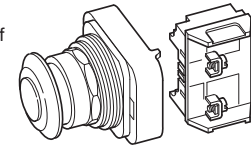

**800 T - FX 1 A1**

a
b
c
d
d
e

Protection Rating	
Code	Description
T	Metal, Type 4/13
H	Plastic, Type 4/4X/13

Finger-Safe Guards	
Code	Description
Blank	No guards
C	Guards on terminals

Head Type†		
800T Type 4/13	Description	800H Type 4/4X/13
Code		Code
FX	Mushroom head (push-pull)	—
FXC	90 mm anodized aluminum head (push-pull)	—
FXJ	Jumbo mushroom head (push-pull)	—
FXJE	Jumbo mushroom head (push-pull) with "E-Stop"	—
FXL	63 mm anodized aluminum head (push-pull)	—
FXLE	63 mm anodized aluminum head (push-pull) with "E-Stop"	—
FXT	Push-pull/twist-to-release	FRXT
FXJT	Jumbo head push-pull with twist-to-release	FRXJT

Color Cap	
Code	Color
Blank	No cap§
1	Green
2	Black
3	Orange
4	Grey
5	White
6	Red
7	Blue
9	Yellow

Contact Block(s)				
Code	Operator Position		Description	
Blank	—	—	No contacts on operator	
Standard				
D1	O	X	1 N.O.	
D2	X	O	1 N.C.	
D4	X	O	1 N.C.L.B.	
A	O	X	1 N.O. - 1 N.C.	
A1	O	X	1 N.O. - 1 N.C.L.B.	
A5	X	O	2 N.C.L.B.	

Contact Block(s)			
Code	Operator Position		Description
Blank	—	—	No contacts
PenTUFF (Low Voltage)			
D1V	O	X	1 N.O.
D2V	X	O	1 N.C.
D4V	X	O	1 N.C.L.B.
AV	O	X	1 N.O. - 1 N.C.
X	X	O	
Class 1, Div. 2/Zone 2			
Logic Reed			
D1R	O	X	1 N.O.
D2R	X	O	1 N.C.
AR	O	X	1 N.O. - 1 N.C.
X	X	O	
Sealed Switch			
D1P	O	X	1 N.O.
D2P	X	O	1 N.C.
AP	O	X	1 N.O.
X	X	O	1 N.C.
Stackable Sealed Switch			
D1Y	O	X	1 N.O.
D2Y	X	O	1 N.C.
AY	O	X	1 N.O. - 1 N.C.
X	X	O	

**Note:** X = Closed/O = Open

\* Normally closed late break contact. When button is pushed from the OUT to IN position, the mechanical detent action of the operator occurs before electrical contacts change state. When the button is pulled from the IN in the OUT position, the electrical contacts change state before the mechanical detent occurs.

† Devices with N.C.L.B. contacts meet EN ISO 13850 and IEC 60947-5-5 standards for emergency stop applications.

§ Not valid with head Type J or JT.

Bulletin 800T/H  
**30.5 mm Push Buttons**  
 Push-Pull Operators

**3-Position Push-Pull Devices, Non-Illuminated**

**Note:** A jumbo or large legend plate is recommended, if space allows.



3-Position Push-Pull  
 Cat. No. 800T-FXM6A7



3-Position Push-Pull  
 Cat. No. 800H-FRXM6A7

Contact Type	Operator Position			Operator Position		
	Momentary	Maintained	Maintained	Momentary	Maintained	Momentary
	Out	Center	In	Out	Center	In
N.C.-	X	O	O	X	O	O
N.C.L.B.*	X	X	O	X	X	O

Button Color	Type 4/13	Type 4/4X/13	Type 4/13	Type 4/4X/13
	Push-Pull*	Push-Pull*	Push-Pull*	Push-Pull*
	Cat. No.	Cat. No.	Cat. No.	Cat. No.
Red	<b>800T-FXM6A7</b>	<b>800H-FRXM6A7</b>	<b>800T-FXN6A7</b>	<b>800H-FRXN6A7</b>

**Note:** X = Closed/O = Open

\* Normally closed late break contact. When button is pushed from the OUT to IN position, the mechanical detent action of the operator occurs before electrical contacts change state. When the button is pulled from the IN to the OUT position, the electrical contacts change state before the mechanical detent occurs.

\* Devices with N.C.L.B. contacts meet EN ISO 13850 and IEC 60947-5-5 standards for emergency stop applications.

**800**   **T**   **- FX**   **M**   **1**   **A7**  
           **a**        **b**        **c**        **d**        **e**        **f**

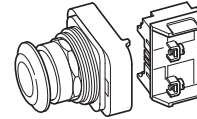

**a**

Protection Rating	
Code	Description
T	Metal, Type 4/13
H	Plastic, Type 4/4X/13

**b**

Finger-Safe Guards	
Code	Description
Blank	No guards
C	Guards on terminals

**c**

Head Type*		
800T Type 4/13	Description	800H Type 4/4X/13
Code		Code
FX	Mushroom head (push-pull)	FRX
FXC	90 mm anodized aluminum head (push-pull)	—
FXJ	Jumbo mushroom head (push-pull)	FRXJ
FXL	63 mm anodized aluminum head (push-pull)	—

**d**

Operator Function			
Code	Operator Position		
	Out	Center	In
M	Momentary	Maintained	Maintained
N	Momentary	Maintained	Momentary

**e**

Color Cap	
Code	Color
Blank	No cap†
1	Green
2	Black
3	Orange
4	Grey
5	White
6	Red
7	Blue
9	Yellow

**f**

Contact Block(s)				
Code	Operator Position			Description
	Out	Ctr.	In	
Blank	—	—	—	No contacts
Standard				
A	O	O	X	1 N.O. - 1 N.C.
	X	O	O	
A1	O	O	X	1 N.O. - 1 N.C.L.B.
	X	X	O	
A7	X	O	O	1 N.C. - 1 N.C.L.B.
	X	X	O	
B6	X	O	O	2 N.C. - 2 N.C.L.B.
	X	X	O	
	X	O	O	
	X	X	O	
PenTUFF (Low Voltage)				
AV	O	O	X	1 N.O. - 1 N.C.
	X	O	O	

**f (cont'd)**

Contact Block(s)				
Code	Operator Position			Description
	Out	Ctr.	In	
Class 1, Div. 2/Zone 2				
Logic Reed				
AR	O	O	X	1 N.O. - 1 N.C.
	X	O	O	
Sealed Switch				
AP	O	O	X	1 N.O. - 1 N.C.
	X	O	O	
Stackable Sealed Switch				
AY	O	O	X	1 N.O. - 1 N.C.
	X	O	O	

**Note:** X = Closed/O = Open

\* Devices with N.C.L.B. contacts meet EN ISO 13850 and IEC 60947-5-5 standards for emergency stop applications.

† Not valid with head Type J.

**2-Position Red Push-Pull and Push-Pull/Twist Release Devices, Illuminated**

Note: A jumbo or large legend plate is recommended, if space allows.



Illuminated 2-Position Push-Pull  
 Cat. No. 800T-FXP16RA1



2-Position Push-Pull  
 Cat. No. 800T-FXJEP16RA1



Illuminated 2-Position Push-Pull/Twist  
 Cat. No. 800T-FXTP16RA1



Illuminated 2-Position Push-Pull/Twist  
 Cat. No. 800H-FRXT16RA1

Type	Lamp Type	Volts	Color	Contacts	Operator Position		Type 4/13			Type 4/4X/13
					Out	In	Push-Pull — 40 mm❖	Push-Pull — 60 mm with "E-Stop"❖	Push-Pull/Twist Release❖	Push-Pull/Twist Release❖
Operator Only*					No Contacts		800T-FXS00X	—	800T-FXTS00X	800H-FRXTS00X
Full Voltage	Incan.	24V AC/DC	Red	N.O. - N.C.L.B. ❖	O	X	800T-FXQ24RA1	800T-FXJEQ24RA1	800T-FXTQ24RA1	800H-FRXTQ24RA1
	No Lamp	0...250V AC/DC	No Lens				800T-FXQN25XA1	—	800T-FXTQN25XA1	800H-FRXTQN25XA1
Universal	LED	12...130V AC/DC	Red	❖	O	X	800T-FXQH2RA1	800T-FXJEQH2RA1	800T-FXTQH2RA1	800H-FRXTQH2RA1
Transformer	Incan.	120V AC	Red	N.O. - N.C.L.B. ❖	O	X	800T-FXP16RA1	800T-FXJEP16RA1	800T-FXTP16RA1	800H-FRXT16RA1
		240V AC					800T-FXP26RA1	800T-FXJEP26RA1	800T-FXTP26RA1	800H-FRXT26RA1
	120V AC	800T-FXPH16RA1					800T-FXJEPH16RA1	800T-FXTPH16RA1	800H-FRXTPH16RA1	
	240V AC	800T-FXPH26RA1					800T-FXJEPH26RA1	800T-FXTPH26RA1	800H-FRXTPH26RA1	
Transformer	No Lamp	120V AC	No Lens	❖	O	X	800T-FXPN16XA1	—	800T-FXTPN16XA1	800H-FRXTPN16XA1

Note: X = Closed/O = Open      Note: Emergency stop push buttons are compliant with EN ISO 13850 and EN/IEC 60947-5-5 Standards when using N.C.L.B. contact blocks.

\* Operator only supplied without power module, lamp, lens cap, or contact blocks.

❖ Normally closed late break contact. When button is pushed from the OUT to IN position, the mechanical detent action of the operator occurs before electrical contacts change state. When the button is pulled from the IN to the OUT position, the electrical contacts change state before the mechanical detent occurs.

❖ Consult your local Rockwell Automation sales office or Allen-Bradley distributor for availability of illuminated E-stops with Self Monitoring Contact Blocks (SMCBs).

**800 T - FX T PH 16 R A1**

a b c d e e f g h

Protection Rating	
Code	Description
T	Metal, Type 4/13
H	Plastic, Type 4/4X/13

Finger-Safe Guards	
Code	Description
Blank	No guards
C	Guards on terminals

Head Type§		
800T Type 4/13	Description	800H Type 4/4X/13
Code		Code
FX	Mushroom head	FRX
FXJ	Jumbo mushroom	FRXJ
FXJE	Jumbo mushroom (push-pull) with "E-Stop"	—

Operator Function	
Code	Description
Blank	Push-pull▲
T	Push-pull/twist

Illumination Options	
Transformer	
Code	Description
P	Incandescent
PH	LED
Full Voltage	
Q	Incandescent
QH	Universal LED
Dual Input	
D	Diode type
DT	Transformer — relay type
DTH	Transformer — relay type LED

Voltage‡	
Transformer	
Code	Description
16	120V AC 50/60 Hz
26	240V AC 50/60 Hz
Full Voltage	
24	24V AC/DC
10	120V AC/DC
20	240V AC/DC
Universal LED	
2	12...130V AC/DC
Dual Input	
16	120V AC
24	24V AC/DC (dual input diode only)

Color Cap	
Code	Color
X	No cap (not valid with head Type J)
A	Amber
B	Blue
C	Clear
G	Green
R	Red
W	White

Target		
Contact	O	X
N.O.		
N.C./N.C.L.B.	X	O

Contact Blocks	
Code	Description
Blank	No contacts
Standard	
D1	1 N.O.
D2	1 N.C.
D4	1 N.C.L.B.
A	1 N.O. - 1 N.C.
A1	1 N.O. - 1 N.C.L.B.
A5	2 N.C.L.B.
PenTUFF (Low Voltage)	
D1V	1 N.O.
D2V	1 N.C.
D4V	1 N.C.L.B.
AV	1 N.O. - 1 N.C.

h (cont'd)

Contact Blocks	
Code	Description
Class 1, Div. 2/Zone 2	
Logic Reed	
D1R	1 N.O.
D2R	1 N.C.
AR	1 N.O. - 1 N.C.
Sealed Switch	
D1P	1 N.O.
D2P	1 N.C.
AP	1 N.O. - 1 N.C.
Stackable Sealed Switch	
D1Y	1 N.O.
D2Y	1 N.C.
AY	1 N.O. - 1 N.C.

‡ See page 10-20 for additional voltage code options.

§ Devices with N.C.L.B. contacts meet EN ISO 13850 and IEC 60947-5-5 standards for emergency stop applications.

▲ Push-Pull is available only with Bul. 800T.

❖ Diode type dual input provides circuit isolation via opposing diodes. Not recommended for use with solid-state outputs.

Bulletin 800T/H  
**30.5 mm Push Buttons**  
 Push-Pull Operators

3-Position Push-Pull Devices, Illuminated



Illuminated 3-Position Push-Pull  
 Cat. No. 800T-FXMP16RA7



Illuminated 3-Position Push-Pull  
 Cat. No. 800H-FRXMP16A7

				Operator Position			Operator Position		
				Momentary	Maintained	Maintained	Momentary	Maintained	Momentary
<b>Contacts</b>				Out	Center	In	Out	Center	In
N.C.-				X	O	O	X	O	O
N.C.L.B.*				X	X	O	X	X	O

Type	Lamp Type	Volts	Color	Type 4/13	Type 4/4X/13	Type 4/13	Type 4/4X/13
				Cat. No.‡	Cat. No.‡	Cat. No.‡	Cat. No.‡
Operator Only*				800T-FXMS00X	800H-FRXMS00X	800T-FXNS00X	800H-FRXNS00X
Full Voltage	Incandescent	24V AC/DC	Red	<b>800T-FXMQ24RA7</b>	800H-FRXMQ24RA7	<b>800T-FXNQ24RA7</b>	800H-FRXNQ24RA7
	No Lamp	0...250V AC/DC	No Lens	800T-FXMQN25XA7	800H-FRXMQN25XA7	800T-FXNQN25XA7	800H-FRXNQN25XA7
Universal	LED	12...130V AC/DC	Red	<b>800T-FXMQH2RA7</b>	800H-FRXMQH2RA7	<b>800T-FXNQH2RA7</b>	800H-FRXNQH2RA7
Transformer	Incandescent	120V AC	Red	<b>800T-FXMP16RA7</b>	<b>800H-FRXMP16RA7</b>	<b>800T-FXNP16RA7</b>	<b>800H-FRXNP16RA7</b>
	LED	120V AC		<b>800T-FXMPH16RA7</b>	800H-FRXMPH16RA7	800T-FXNPH16RA7	800H-FRXNPH16RA7
	No Lamp	120V AC	No Lens	800T-FXMPN16XA7	800H-FRXMPN16XA7	800T-FXNPN16XA7	800H-FRXNPN16XA7

Note: X = Closed/O = Open

\* Normally closed late break contact. When button is pushed from the OUT to IN position, the mechanical detent action of the operator occurs before electrical contacts change state. When the button is pulled from the IN to the OUT position, the electrical contacts change state before the mechanical detent occurs.

\* Operator only supplied without power module, lamp, lens cap, or contact blocks.

‡ Devices with N.C.L.B. contacts meet EN ISO 13850 and EN/IEC 60947-5-5 standards for emergency stop applications.

**800 T - FX M PH 16 R A1**  
 a b c d e f g h

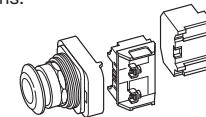

**a**

Protection Rating	
Code	Description
T	Metal, Type 4/13
H	Plastic, Type 4/4X/13

**b**

Finger-Safe Guards	
Code	Description
Blank	No guards
C	Guards on terminals

**c**

Head Type‡		
800T Type 4/13	Description	800H Type 4/4X/13
Code		Code
FX	Mushroom head	FRX
FXJ	Jumbo mushroom	FRXJ

**d**

Operator Function			
Code	Operator Position		
M	Mom.	Main.	Main.
N	Mom.	Main.	Mom.

Mom. – Momentary, Main. – Maintained.

**e**

Illumination Options	
Transformer	
Code	Description
P	Incandescent
PH	LED
Full Voltage	
Q	Incandescent
QH	Universal LED
Dual Input	
D	Diode type
DT	Transformer — relay type
DTH	Transformer — relay LED

**f**

Voltage§	
Transformer	
Code	Description
16	120V AC 50/60 Hz
26	240V AC 50/60 Hz
Full Voltage	
24	24V AC/DC
10	120V AC/DC
20	240V AC/DC
Universal LED	
2	12...130V AC/DC
Dual Input	
16	120V AC
24	24V AC/DC▲

**g**

Color Cap	
Code	Color
X	No cap (not valid with head Type J)
A	Amber
B	Blue
C	Clear
G	Green
R	Red
W	White

**h**

Target			
Contact			
N.O.	O	O	X
N.C.	X	O	O
N.C.L.B.	X	X	O
Contact Blocks			
Code	Description		
Blank	No contacts on operator		
Standard			
A	1 N.O. - 1 N.C.		
A1	1 N.O. - 1 N.C.L.B.		
A7	1 N.C. - 1 N.C.L.B.		
PenTUFF (Low Voltage)			
AV	1 N.O. - 1 N.C.		
Class 1, Div. 2/Zone 2			
Logic Reed			
AR	1 N.O. - 1 N.C.		
Sealed Switch			
AP	1 N.O. - 1 N.C.		
Stackable Sealed Switch			
AY	1 N.O. - 1 N.C.		

§ See page 10-20 (Table f) for additional voltage code options.

‡ Devices with N.C.L.B. contacts meet EN ISO 13850 and EN/IEC 60947-5-5 standards for emergency stop applications.

‡ Diode type dual input provides circuit isolation via opposing diodes. Not recommended for use with solid-state outputs.

▲ Dual input diode only.

# 30.5 mm Push Buttons

## Approximate Dimensions

Dimensions in inches (millimeters). Dimensions are not intended to be used for manufacturing purposes.

### Push Buttons and Switches (Bul. 800T Only)

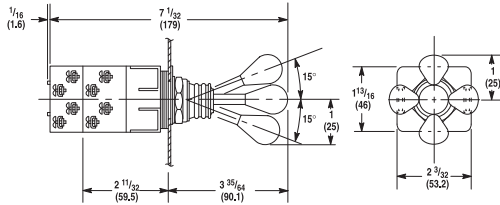

**2-3-4 Way Switch**  
**Shipping Wt. with 2 Contact Blocks 6 oz (0.17 kg)**  
**Shipping Wt. with 4 Contact Blocks 8-1/2 oz (0.24 kg)**

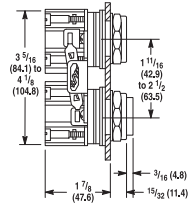

**Mechanically Interlocked Maintained Contact Push Button**  
**Shipping Wt. 1 lb (0.45 kg)**

### Push Buttons and Pilot Lights

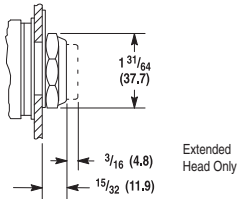

**Flush and Extended Head Push Button**  
**Shipping Wt. 5-1/2 oz (0.15 kg)**

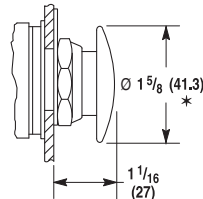

**Mushroom Head Push Button**  
**Shipping Wt. 7-1/2 oz (0.21 kg)**

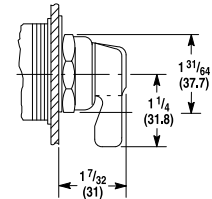

**Non-Illuminated Knob Lever and Standard Knob Selector Switch**  
**Shipping Wt. 6 oz (0.17 kg)**

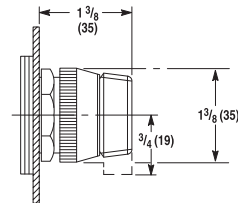

**Illuminated Knob Lever and Standard Knob Selector Switch**  
**Shipping Wt. 6 oz (0.17 kg)**

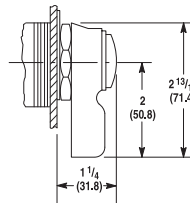

**Wing Lever Selector Switch**  
**Shipping Wt. 8 oz (0.22 kg)**

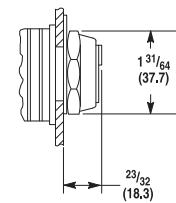

**Coin Slot Selector Switch**  
**Shipping Wt. 6 oz (0.17 kg)**

\* Except jumbo which is 2-1/4 (57.2).

### Operator Extension in Front of Panel (Bul. 800T Only)

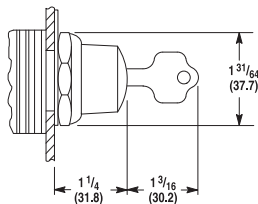

**Key Operated Selector Switch**  
**Shipping Wt. 12 oz (0.34 kg)**

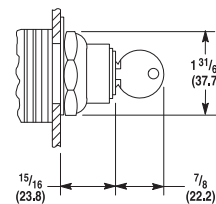

**Push Button with Cylinder Lock**  
**Shipping Wt. 12 oz (0.34 kg)**

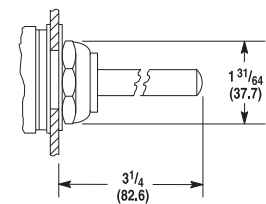

**Wobble Stick**  
**Shipping Wt. 9 oz (0.25 kg)**

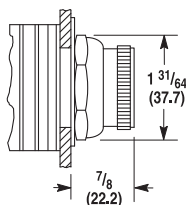

**Selector Push Button**  
**Shipping Wt. 6 oz (0.17 kg)**

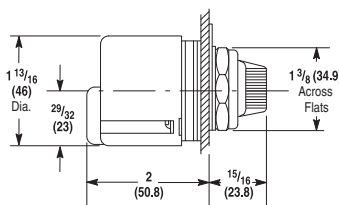

**Type J Potentiometer Unit**  
**Shipping Wt. 4 oz (0.11 kg)**

