

STEEL HAWG® CUTTERS



THREADED STEEL HAWG® CUTTERS

FAST CUTTING

- Alternating tooth geometry for up to 3X faster cutting

LONG LIFE

- Hardened carbide steel teeth provide longer life

2" CUTTING DEPTH



Size	Part Number
3/4"	49-57-0750
13/16"	49-57-0812
7/8"	49-57-0875
15/16"	49-57-0937
1"	49-57-1000
1-1/16"	49-57-1062
1-1/8"	49-57-1125
1-3/16"	49-57-1187
1-1/4"	49-57-1250
1-5/16"	49-57-1312
1-3/8"	49-57-1375
1-7/16"	49-57-1437
1-1/2"	49-57-1500
1-9/16"	49-57-1562
1-5/8"	49-57-1625
1-11/16"	49-57-1687
1-3/4"	49-57-1750
1-13/16"	49-57-1812
1-7/8"	49-57-1875
1-15/16"	49-57-1937
2"	49-57-2000
2-1/16"	49-57-2060
2-1/8"	49-57-2120
2-1/4"	49-57-2250
2-5/16"	49-57-2310

Size	Part Number
2-3/8"	49-57-2370
2-1/2"	49-57-2500
2-9/16"	49-57-2560
2-5/8"	49-57-2620
2-3/4"	49-57-2750
2-7/8"	49-57-2870
3"	49-57-3000
3-1/8"	49-57-3120
3-1/4"	49-57-3250
3-3/8"	49-57-3370
3-1/2"	49-57-3500
3-5/8"	49-57-3620
3-3/4"	49-57-3750
3-7/8"	49-57-3870
4"	49-57-4000
4-1/8"	49-57-4120
4-1/4"	49-57-4250
4-3/8"	49-57-4370
4-1/2"	49-57-4500
4-5/8"	49-57-4620
4-3/4"	49-57-4750
5"	49-57-5000
5-1/2"	49-57-5500
6"	49-57-6000

FOR USE WITH MILWAUKEE ELECTROMAGNETIC DRILL PRESSES AND DRILL STANDS

- **Two Styles: Threaded Or Quik-Lok With Appropriate Arbor Assemblies**
- **Carbide-Tipped Multiple Cutting Edges** – MILWAUKEE steel hawk cutters are high efficient carbide-tipped cutting tools. Alternating inside and outside cutting edges are carefully honed to cut holes rapidly with great precision.
- **Hardened Carbide** – Last longer than regular twist drills. The steel hawk cutters' multiple cutting edges uniformly distribute cutting over a wider area than a two flute twist drill tip.
- **Large Hole Cutters, Maximum 2" Depth, Up To 6" Diameter For Steel Plate, Stainless Steel, Cast Iron Or Aluminum**
- **3 Times Faster Than Twist Drills In Steel, Stainless Or Non-Ferrous Metals**

ARBORS



#3 Morse Taper Arbor 49-57-0010	3/4" Shank Arbor 49-57-0030
<ul style="list-style-type: none"> ▪ Works with threaded STEEL HAWG® cutters ▪ Use with motors 4292-1 and 4297-1 	<ul style="list-style-type: none"> ▪ Works with threaded STEEL HAWG® cutters ▪ Use with 4262-1 motor
Includes: <ul style="list-style-type: none"> ▪ Oil hose and hand pump 	Includes: <ul style="list-style-type: none"> ▪ Oil hose and hand pump

QUICK CHANGE TANG STEEL HAWG® CUTTERS

FAST CUTTING

- Alternating tooth geometry for up to 3X faster cutting with less pressure and better results than twist drill bits
- No pre-punching or pilot holes

LONG LIFE

- Hardened carbide steel teeth provide longer life

QUICK CHANGE

- Tool-free operation for fast changes

1" CUTTING DEPTH



Size	Part Number
1/2"	49-57-0251
9/16"	49-57-0564
5/8"	49-57-0626
11/16"	49-57-0689
3/4"	49-57-0752
13/16"	49-57-0814
7/8"	49-57-0877
15/16"	49-57-0939
1"	49-57-1002
1-1/16"	49-57-1064
1-1/8"	49-57-1127
1-3/16"	49-57-1189
1-1/4"	49-57-1252

Size	Part Number
1-5/16"	49-57-1314
1-3/8"	49-57-1377
1-7/16"	49-57-1439
1-1/2"	49-57-1502
1-9/16"	49-57-1564
1-5/8"	49-57-1627
1-11/16"	49-57-1689
1-3/4"	49-57-1752
1-13/16"	49-57-1814
1-7/8"	49-57-1877
1-15/16"	49-57-1939
2"	49-57-2002

ARBORS



#3 Morse Taper Quick Change Arbor 49-57-0012	#3 Morse Taper Quick Change Arbor w/Chip Breaker 49-57-0013	3/4" Straight Shank Quick Change Arbor 49-57-0032
<ul style="list-style-type: none"> ▪ Works with quick-change tang STEEL HAWG® cutters ▪ Use with motors 4292-1 and 4297-1 	<ul style="list-style-type: none"> ▪ Works with quick-change tang STEEL HAWG® cutters ▪ Use with motors 4292-1 and 4297-1 	<ul style="list-style-type: none"> ▪ Works with quick-change tang STEEL HAWG® cutters ▪ Use with 4262-1 motor
Includes: <ul style="list-style-type: none"> ▪ Oil hose and hand pump 	Includes: <ul style="list-style-type: none"> ▪ Oil hose and hand pump 	Includes: <ul style="list-style-type: none"> ▪ Oil hose and hand pump

ONE PIECE STEEL HAWG® CUTTERS

1/2" CUTTING DEPTH

- Recommended for use with Milwaukee® electromagnetic drill presses or hand drill

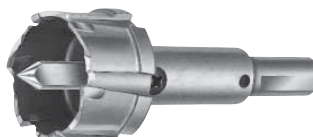

Size	Part Number
11/16"	49-57-8068
13/16"	49-57-8081
Pilot Bit	49-57-0038