

Hammer-On Flange Clip, Bottom Mount – M912

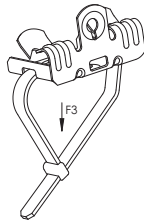

- Can be used to support boxes, fixtures or other applications from beam flanges
- Assorted attachment points provided to reduce inventory
- Requires only a hammer to install

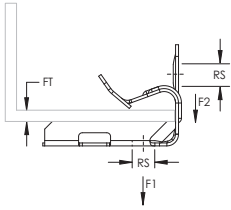

Part Number	M912
Material	Spring Steel
Finish	CADDY® ARMOUR
Flange Thickness (FT)	9/16" – 3/4"
Rod Size (RS)	1/4"
Static Load 1 (F1)	100 lb
Static Load 2 (F2)	25 lb
Static Load 3 (F3)	75 lb
Certifications	cULus
Standard Packaging Quantity	100 pc
UPC	78285618100

UL, UR, cUL, cUR, cULus and cURus are registered certification marks of UL LLC.

WARNING

ERICO products shall be installed and used only as indicated in ERICO's product instruction sheets and training materials. Instruction sheets are available at www.erico.com and from your ERICO customer service representative. Improper installation, misuse, misapplication or other failure to completely follow ERICO's instructions and warnings may cause product malfunction, property damage, serious bodily injury and death.

Copyright © 2015 ERICO International Corporation. All rights reserved.

CADDY, CADWELD, CRITEC, ERICO, ERIFLEX, ERITECH, and LENTON are registered trademarks of ERICO International Corporation.

